

# VZ-IP-PVMN SERIES

## 23", 27", 32" & 43" IP PUBLIC VIEW MONITOR

---

### IP-PVM N USER MANUAL



**ViewZ<sup>®</sup>**  
[www.viewzusa.com](http://www.viewzusa.com)

This device complies with NDAA (National Defense Authorization Act).

Please read this manual thoroughly before use, and keep it handy for future reference.

# CONTENTS

**Safety Instruction** ..... 3

    1. Mark Indication & Substance ..... 4

    2. Warning ..... 4

    3. Caution ..... 5

    4. Operational Temperature & Humidity ..... 5

    5. Dot Defect (dead pixel) of TFT ..... 5

    6. FCC RF INTERFERENCE STATEMENT ..... 6

    7. WIRING (DC 24V) ..... 7

**Installation** ..... 8

    1. Package ..... 8

    2. Interface ..... 9

    3. Remote Control Function ..... 12

**Function** ..... 13

    1. Monitor Button Function ..... 14

    2. OSD Control and Function ..... 15

**Mounting Guide** ..... 25

**Specification** ..... 26

**Trouble Shooting** ..... 30

**RMA** ..... 31

**Warranty** ..... 32

# SAFETY INSTRUCTION

## Important Safety Instruction

1. Read all warnings.
2. Follow all instructions to ensure longevity of monitor.
3. Do not place the monitor near water.
4. Clean only with dry cloth.
5. Do not block any ventilation openings. Install in accordance with the manufacturer's instructions.
6. Do not install near any heat sources such as radiators, heat registers, stoves, or other heat generating devices.
7. Do not override the safety purpose of the polarized or grounding-type plug.
8. A polarized plug has two blades with one wider than the other.
9. A grounding type plug has two blades and a third grounding prong.
10. The wide blade and the third prong are provided for your safety.
11. If the provided plug does not fit into your outlet, consult with electrician for replacement of the outlet.
12. Protect the power cord from being walked on or pinched particularly at plugs, convenience receptacles and the point where it connects to the monitor.
13. Only use attachment/accessories specified by the manufacturer.
14. Use only with the cart, stand, tripod, bracket or table specified by the manufacturer or sold with the monitor. When a cart is used, use caution when moving the cart & monitor in combination to avoid injuries.
15. Unplug the monitor during lightning storms or when unused for long periods of time.
16. Refer all servicing to qualified service personnel. Servicing is required when the monitor has been damaged in any way.



The monitor shall not be exposed to dripping or splashing and objects containing liquids, such as vases shall not be placed near the monitor.

The monitor should have ample distance (e.g. 10cm) from the wall for sufficient ventilation.

# SAFETY INSTRUCTION

## Important Safety Instruction

### Mark Indication and Substance



CAUTION : TO REDUCE THE RISK OF ELECTRICAL SHOCK,  
DO NOT REMOVE COVER (OR BACK). NO USER  
SERVICEABLE PARTS INSIDE. REFER SERVICING TO  
QUALIFIED SERVICE PERSONNEL



This symbol is intended to alert the user to the presence of uninsulated & dangerous voltage within the monitor's enclosure that may be of sufficient magnitude to constitute a risk of electric shock to persons.



This symbol is intended to alert the user to the presence of important operating and maintenance (servicing) instructions in the literature accompanying the monitor.

### Warning

- Do not use damaged or loose cables and plug.
- Do not pull the plug out by the wire nor touch the plug with wet hands.
- Use only a properly grounded plug and receptacle.
- Do not connect too many extension cords or plugs to one outlet.
- Do not excessively bend the plug and wire.
- Do not disconnect the power cord while it's still plugged into the monitor.
- Do not place any heavy objects on the power cord. Damage to the cord may cause shock or fire.
- Never open the monitor. There are no user-serviceable parts inside and opening will void warranty.
- Removing covers may expose you to dangerous shock hazards or other risks.
- Keep any heating devices away from the power cable and monitor.
- Do not place the monitor near water.
- Do not insert objects of any kind into the monitor's open slots, as they may touch dangerous voltage points.
- Please follow the laws and regulations of your municipality to dispose the monitor properly.
- Do not use the monitor in high temperature, humid, dusty or oily areas.
- Do not install the monitor where it will be exposed to continual vibration.
- Keep the plastic packaging out of children's reach.
- If any damage is detected upon first opening the box, contact agency from which you bought the monitor directly.
- If your monitor does not operate normally – in particular, if there is any unusual sound or smell coming from the monitor – unplug it immediately and contact an authorized dealer or the service center.



# SAFETY INSTRUCTION

## Important Safety Instruction

### Caution

- If the connector between the plug and the pin is dusty or dirty, clean it properly using a dry cloth.
- Make sure to unplug the power cord before cleaning the monitor.
- Make sure to leave a gap between monitor and wall.
- Do not drop the monitor when moving it.
- Place your monitor in a location with low humidity and minimum dust.
- Install the monitor base on a showcase or shelf so that the end of the base does not protrude from the showcase or shelf.
- Do not place the monitor on an unstable or small surface area.
- Do not install inside a vehicle.
- Disconnect the plug from the outlet during storms or lightning or if it has not been used for a long time.
- Do not try to move the monitor by pulling on the power cord.
- Do not cover the vents on the monitor.
- When moving the monitor, turn off and unplug the power cord. Make sure that all cables, including HDMI cable and cables connected to other devices, are disconnected before moving it.
- Place the monitor out of children's reach, as they could damage it by hanging onto it.

### Available Temperature & Humidity

- Operating Temperature : 32°F ~ 104°F / 0°C ~ 40°C
- Operating Humidity : 20 ~ 70% RH

## Dot Defect (dead pixel) of TFT

ViewZ monitors are manufactured using high-end semiconductor technology with precision ratings of 99.9% and above. However, it may be the case that certain RGB and white pixels seem darker (or entirely unlit i.e. black).

Modern production methods cannot guarantee an absolute fault-free monitor. To this effect, no LED manufacturer can guarantee a defect free panel. A few isolated pixel or sub-pixel faults are considered tolerable and different policies exist that govern the amount of these tolerable values.

While most pixel faults occur in isolated regions, a cluster of dead pixels or sub-pixels can sometimes form for which a separate ruling applies. A cluster is defined as an area of 5x5 pixels. ViewZ's policy on pixel failure: either as an isolated fault or in the form of a cluster is outlined on the website: [www.viewzusa.com](http://www.viewzusa.com)

# FCC RF INTERFERENCE STATEMENT

## Note

This equipment has been tested and found to comply with the limits for a Class A digital device, pursuant to part 15 of the FCC Rules. These limits are designed to provide reasonable protection against harmful interference when the equipment is operated in a commercial environment.

This equipment generates, uses, and can radiate radio frequency energy and, if not installed and used in accordance with the instruction manual, may cause harmful interference to radio communications. Operation of this equipment in a residential area is likely to cause harmful interference in which case the user will be required to correct the interference at his own expense.

- Reorient or relocate the receiving antenna.
- Increase the separation between the equipment and receiver.
- Connect the equipment into an outlet on a circuit different from that to which the receiver is connected.
- Consult the dealer or an experienced radio, TV technician for help.
- Only shielded interface cable should be used.

Finally, any changes or modifications to the equipment by the user not expressly approved by the grantee or manufacturer could void the users authority to operate such equipment.

### ► DOC COMPLIANCE NOTICE

This digital apparatus does not exceed the Class A limits for radio noise emissions from digital apparatus set out in the radio interference regulation of Canadian Department of communications.

## Statement

- VGA and XGA are the registered trademark of IBM.
- VESA is the trademark of Video Electronics Standard Association.
- HDMI, HDMI logo and High-Definition Multimedia Interface (high definition multimedia digital interface) are the trademark or registered trademark of HDMI Licensing LLC.



If some company or product trademark is not particularly stated, the use of trademark has been fully recognized. Do not alter, decompile, disassemble, decode or conduct reverse engineering to the software installed in the product, or it can be deemed as breach of the law.

# WIRING

## WIRING (DC 24V input only)

1. On the back of the monitor, loosen the thumb screws and lower the access panel.
2. Attach the leads from the power supply (supplied) to the left and right connectors.



**WARNING:** Do not connect a ground to the center post. Please be careful of voltage polarity.

3. When finished, secure the access panel.  
Table A shows the recommended maximum wiring distances (transformer to load), and are calculated with a 10-percent voltage drop.

Input : Power Source output terminal / Output : Set input terminal

VZ-DC24-320 ( Power Transformer) Test Result

### 23" IP-PVM-N - 3 MONITORS - VZ-PVM-I2B3N & I2W3N

Cable Type - 18AWG (Current : 12~19 A)	1 Set of IP-PVM-N			2 Set of IP-PVM-N			3 Set of IP-PVM-N		
ft / meter	DC 24V	DC 27V	Max. V	DC 24V	DC 27V	Max. V	DC 24V	DC 27V	Max. V
100 ft / 30.48 m	tested	tested	tested	tested	tested	tested	tested	tested	tested
150 ft / 45.72 m	tested	tested	tested	tested	tested	tested	tested	tested	tested
200 ft / 60.96 m	tested	tested	tested	tested	tested	tested	tested	tested	tested
250 ft / 76.20 m	tested	tested	tested	tested	tested	tested	tested	tested	tested
300 ft / 91.44 m		tested	tested		tested	tested		tested	tested
350 ft / 106.68 m			tested			tested			tested

### 27" IP-PVM-N - 3 MONITORS - VZ-PVM-I3B3N & I3W3N

Cable Type - 18AWG (Current : 12~19 A)	1 Set of IP-PVM-N			2 Set of IP-PVM-N			3 Set of IP-PVM-N		
ft / meter	DC 24V	DC 27V	Max. V	DC 24V	DC 27V	Max. V	DC 24V	DC 27V	Max. V
100 ft / 30.48 m	tested	tested	tested	tested	tested	tested	tested	tested	tested
150 ft / 45.72 m	tested	tested	tested	tested	tested	tested	tested	tested	tested
200 ft / 60.96 m	tested	tested	tested	tested	tested	tested	tested	tested	tested
250 ft / 76.20 m		tested	tested		tested	tested		tested	tested
300 ft / 91.44 m									
350 ft / 106.68 m				Not Recommended					

### 32" IP-PVM-N - 3 MONITORS - VZ-PVM-I4B3N & I4W3N

Cable Type - 18AWG (Current : 12~19 A)	1 Set of IP-PVM-N			2 Set of IP-PVM-N			3 Set of IP-PVM-N		
ft / meter	DC 24V	DC 27V	Max. V	DC 24V	DC 27V	Max. V	DC 24V	DC 27V	Max. V
100 ft / 30.48 m	tested	tested	tested	tested	tested	tested	tested	tested	tested
150 ft / 45.72 m	tested	tested	tested	tested	tested	tested	tested	tested	tested
200 ft / 60.96 m		tested	tested		tested	tested		tested	tested
250 ft / 76.20 m									
300 ft / 91.44 m				Not Recommended					
350 ft / 106.68 m									

# INSTALLATION





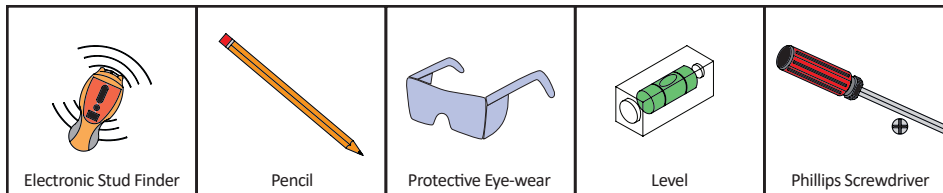

## Installation Tools

The following tools may be required depending on your installation.

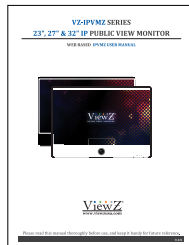

## Assembly Components - provided

Your ViewZ monitor is shipped with all proper installation hardware and components. If there are parts missing and/or damaged, please stop the installation and contact ViewZ USA at (888)-998-4399.

	For 23, 27 & 32" IP PVM	 	For 23, 27 & 32" IP PVM
	 DC 24V Connector (Pig Tail) (Qty 1)		 DC 24V Power Adapter (Qty 1)
Public View Monitor (Qty 1)	For 43" IP PVM	Quick Reference Guide (Qty 1) Remote Controller (Qty 1)	For 43" IP PVM
	 DC24V Connector (Qty 1)		 Power Cable (Qty 1)

## Mounting Option

Your ViewZ monitor is compatible with ViewZ monitor mounts. For more information, please contact ViewZ USA at (888)-998-4399.

### Wall Mount

• Part # <b>WM05</b>	• Flat Wall Mount	• Part # <b>AM02-A</b>	• Tilting -20° ~ 20°	• Part # <b>WM50</b>	• Tilting -10° ~ 0°
	• VESA 75 ~ 100		• Swivel 180°		• Universal Mount
	23" PVM		• VESA 75 ~ 200		• Load Capacity
			23,27,32" PVM		165 lbs / 75 kg
					27,32,43" PVM

### Ceiling Mount

• Part # <b>CM-308</b>	• Tilting -5° ~ 45°	• Part # <b>CMKIT-02</b>	• Tilting -12° ~ +5°
	• Rotation 360°		• Rotation 360°
	• Black / White		• Poll : 35" ~ 70"
	• Poll : 3 ~ 18 ft		23,27,32,43" PVM
	23,27,32,43" PVM		

# CONNECT EXTERNAL EQUIPMENTS

## 23", 27" & 32" IP PVM Interface Input Ports

The following image is the description of interface input ports

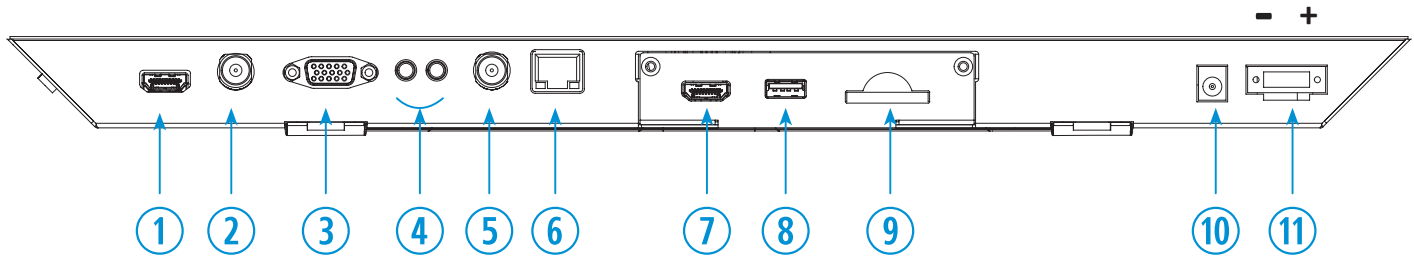

- |                                  |                                     |
|----------------------------------|-------------------------------------|
| 1. HDMI IN                       | 7. (Optional) Media Player HDMI OUT |
| 2. AV ( BNC ) IN                 | 8. (Optional) Media Player USB      |
| 3. VGA (15 Pin D-Sub) IN         | 9. (Optional) Media Player SD IN    |
| 4. AUDIO OUT / IN                | 10. DC 12V OUT                      |
| 5. CAMERA CVBS OUT               | 11. DC 24V IN                       |
| 6. CAMERA IP(Ethernet) OUT / PoE |                                     |

## 43" IP PVM Interface Input Ports

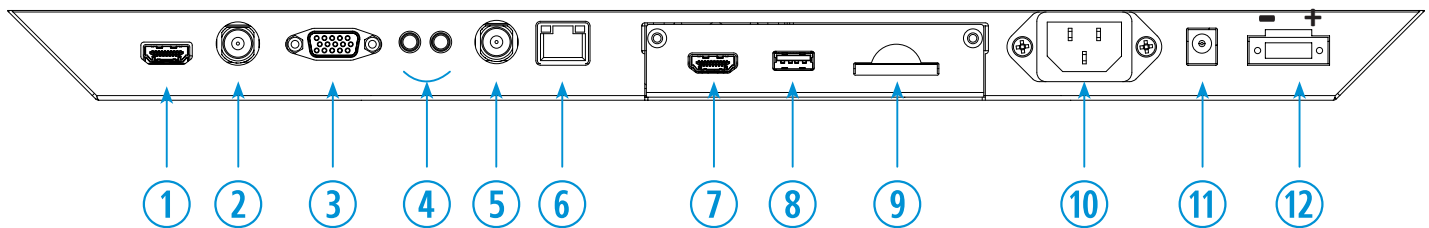

- |                            |                                     |
|----------------------------|-------------------------------------|
| 1. HDMI IN                 | 7. (Optional) Media Player HDMI OUT |
| 2. AV ( BNC ) IN           | 8. (Optional) Media Player USB      |
| 3. VGA (15 Pin D-Sub) IN   | 9. (Optional) Media Player SD Card  |
| 4. AUDIO IN / OUT          | 10. AC 110V IN                      |
| 5. CAMERA CVBS OUT         | 11. DC 12V OUT                      |
| 6. CAMERA IP(Ethernet) OUT | 12. DC 24V IN                       |

### Warning

When you plugin into the green terminal connector (DC24V), please be careful about the + & - sign.  
If you do not follow the + & - sign, it causes a serious damage to the monitor.

# CONNECT EXTERNAL EQUIPMENTS

## Precaution on DC 12V-Out / DC 24V-In Installation of 23", 27" & 32" IP PVM

The following image is the description of interface input ports

① Prepare a DC 24V power supply & a pigtail

② Connect a DC 24V power supply & a pigtail

③ Use the combined cable & plug in to DC 24V female port of IP PVM

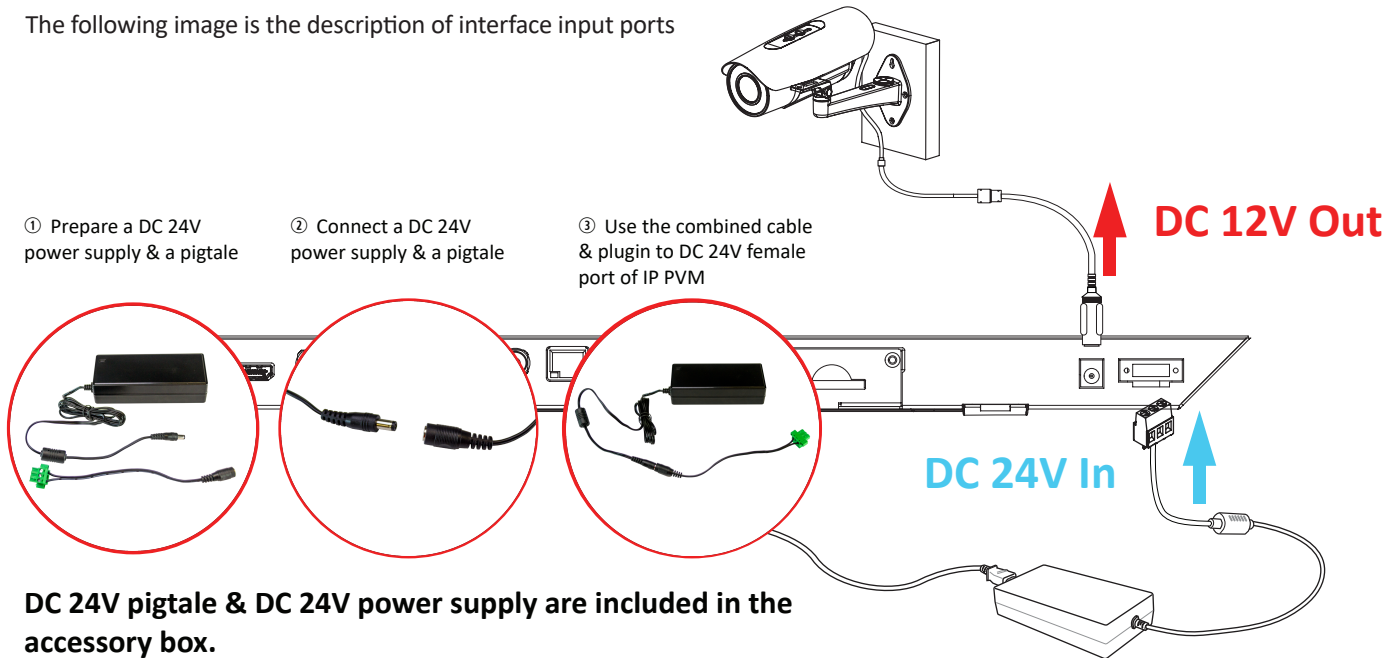

## Precaution on DC 12V-Out / DC 24V-In Installation of 43" IP PVM

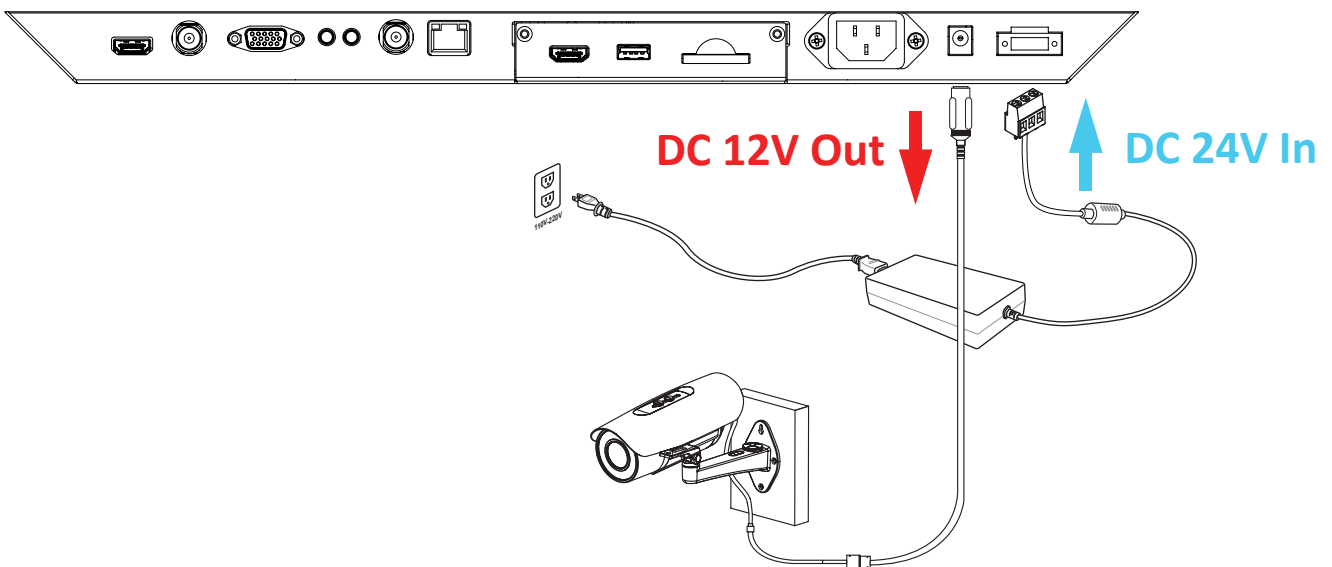

### Connection Safety !

ViewZ 23", 27", 32" & 43" **do not have DC 12V-IN**. Do not plug in the IP PVM's DC 12V female connector.

# CONNECT EXTERNAL EQUIPMENTS

## TF Card (for recording) Installation of 23", 27", 32" & 43" IP PVM

The following image is the description of TF card installation

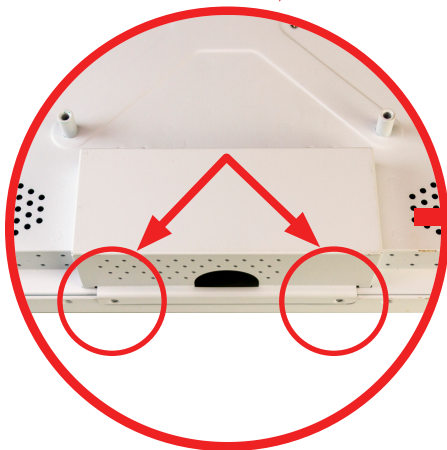
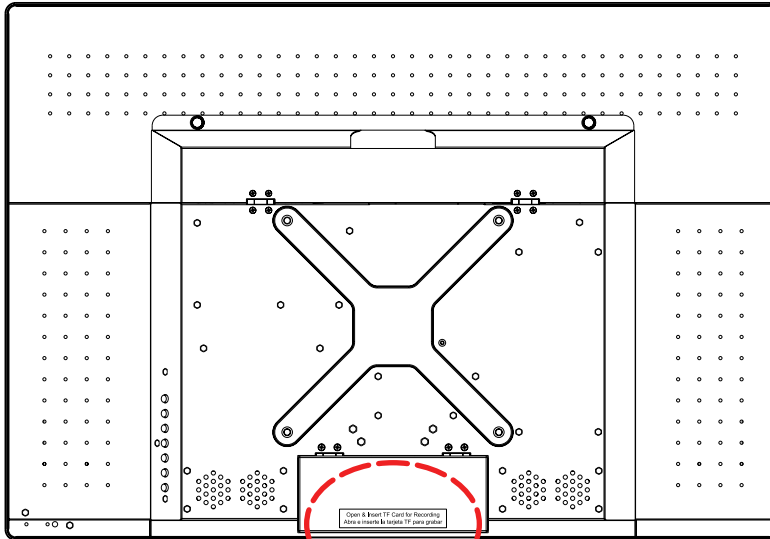

① Place the IP PVM on the flat area and unscrew 2 bolts

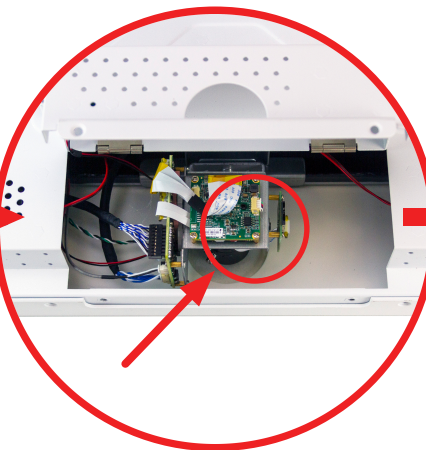

② Open the bottom part and see the side of camera module. User will see the empty TF (Micro SD) card slot.

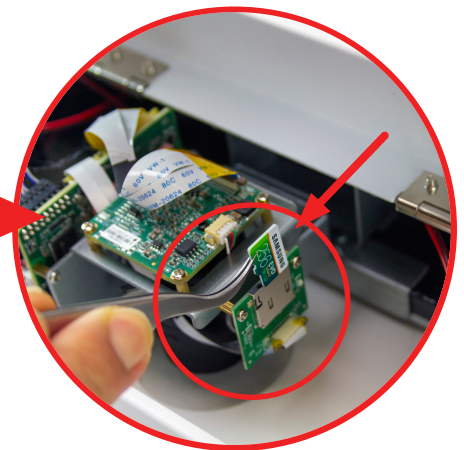

③ Insert a TF (Micro SD) card to the slot and lock the bottom part.



### Note

Please refer the page 88 of IPPVM web user manual to see how to process the recording

# REMOTE FUNCTION

## Remote Controller

### Remote Controller

1. **Power**
2. **Source** - Select Input Source
3. **Mute** - Turn off the sound
4. **Menu** - Enter / Exit OSD
5. **Exit** - Exit OSD with saving current value
6. **Left & Right** ◀(VOL)▶, **Up & Down** ▲▼
7. **Enter** - Select current setting value on Input source
8. **PIP, SWAP, P.POS, P.Size, S.Sat, ARC, APC, ACC**  
- Not working

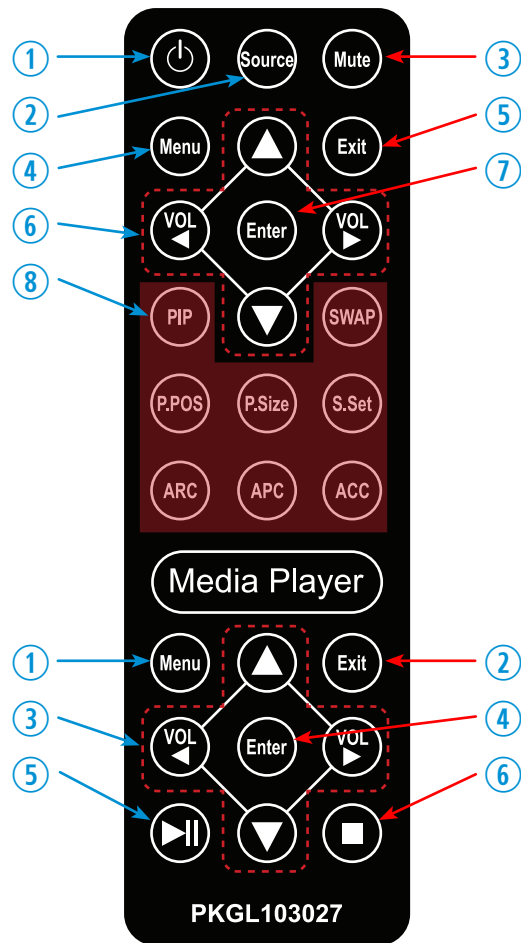

### Media Controller

1. **Menu** - Enter / Exit Media Player Menu
2. **Exit** - Exit Media Player Menu
3. **Left & Right** ◀(VOL)▶, **Up & Down** ▲▼
4. **Enter** - Confirm the selection
5. **Stop & Play** - Freeze the media play
6. **Stop** - Stop the media play

Display image, sound and custom settings can be adjusted in OSD (On Screen Display) menu by remote controller.  
To adjust monitor setting value :

1. Press the '**MENU**' button to enter the OSD menu
2. Press the '**INPUT**' button to select input source
3. Press the ▲ / ▼ buttons to select the desired sub-menu. The selected submenu will be highlighted
4. Press the '**ENTER**' button to enter the sub-menu for adjusting items
5. Change the value you wish to adjust by using the ◀ / ▶ buttons
6. Press the '**MENU**' button to confirm / exit for saving adjustment value on sub-menu
7. Without entering OSD MENU, press ◀ / ▶ buttons to adjust the audio volume
8. Press the '**MUTE**' button to on / off audio - audio only works with VGA / AV input



# CONTROL AND FUNCTION

## On Monitor, Front Area

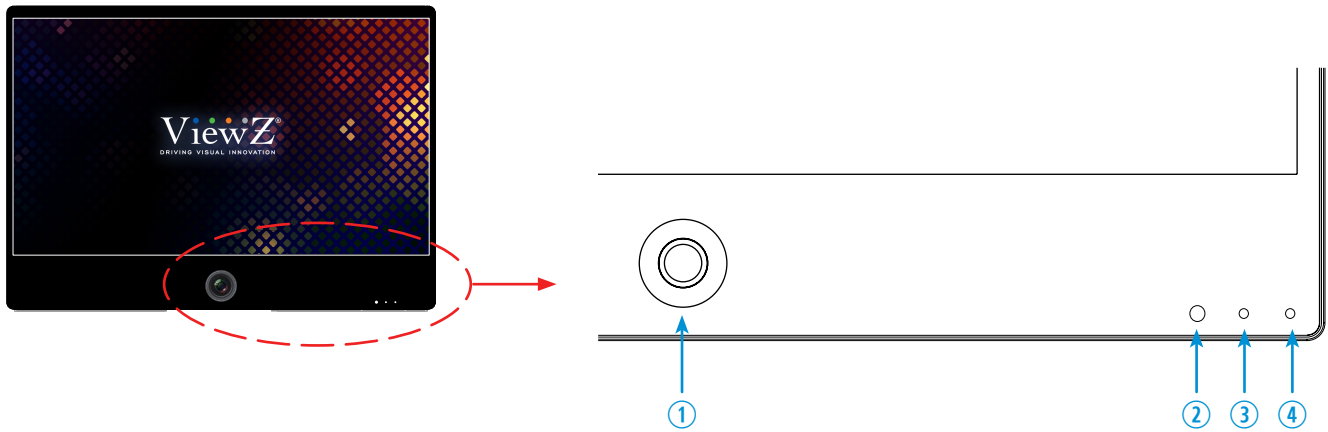

1. Built-in Camera / Motion Detection  
The monitor will display the built-in camera's video  
Built-in camera has the motion detection function
2. IR Sensor  
Sensor for the remote controller
3. LED Indicator  
Green color: monitor on  
Red color : monitor off
4. Recording Indicator LED  
User can choose a blinking LED color - red, blue, purple and no color.

# CONTROL AND FUNCTION

## On Monitor, Button Control

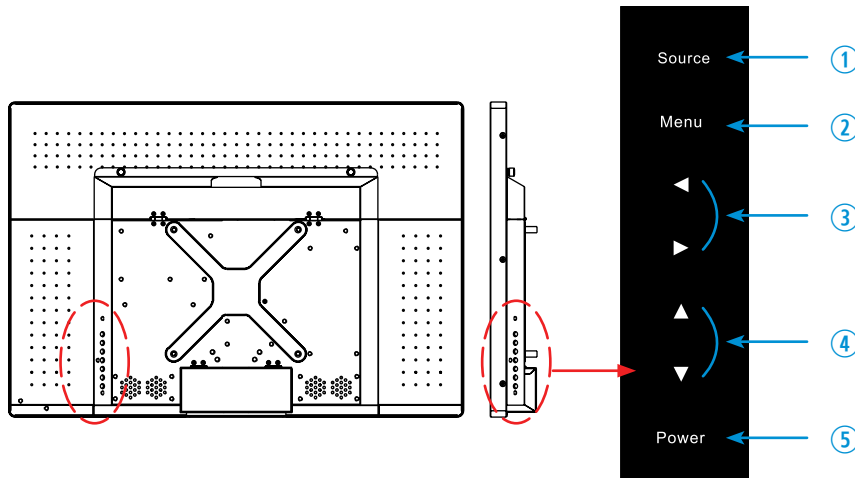

- |  |   |
|--|---|
| <ol style="list-style-type: none"> <li>1. Source<br/>To select an input source</li> <li>2. Menu<br/>To enter or exit the OSD / Select a menu on OSD</li> <li>3. Left &amp; Right ◀ (VOL) ▶<br/>To change the value on the selected menu</li> <li>4. Up &amp; Down ▲ ▼<br/>To switch a menu on OSD</li> </ol> | <ol style="list-style-type: none"> <li>5. Power<br/>To turn the monitor power on / off</li> </ol> |
|--|---|

## Monitor Button Function

All picture, sound settings and setup can be adjusted in OSD (On Screen Display) menu.

To adjust the OSD screen:

1. Press the **MENU** button to enter the **OSD MENU**
2. Press the ◀ / ▶ buttons to select the desired **main-MENU**. The selected **main-MENU** is highlighted
3. Press the ▲ / ▼ buttons to select the desired **sub-MENU**. The selected **sub-MENU** is highlighted
4. Change the value you wish to adjust by using the ◀ / ▶ buttons
5. Press the **MENU** button to confirm the adjustment on **sub-MENU**
6. Press the **MENU** button to exit the **sub-MENU** and go back to the **main-MENU**
7. Press the **MENU** button to exit the **OSD MENU**

# CONTROL AND FUNCTION

## Select Input Source

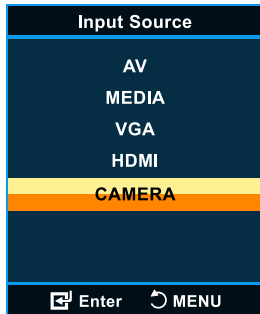

Press 'SOURCE' button on monitor or 'INPUT' button on remote controller.

Press ▲ / ▼ button to change input source and then press ◀ / ▶ button to select input source on monitor.

Press ▲ / ▼ button to change input source and then press ◀ / ▶ button or Enter to select input source on remote controller.

## Volume



Press ◀ / ▶ buttons to adjust volume on monitor

Press ◀ / ▶ buttons to adjust volume on remote controller

## Detect Source Signal Message

If you connect any input source, monitor will display current input source resolution and frequency.

# CONTROL AND FUNCTION

## Picture

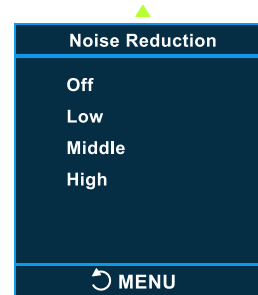
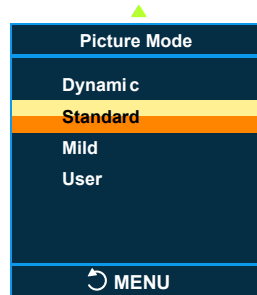
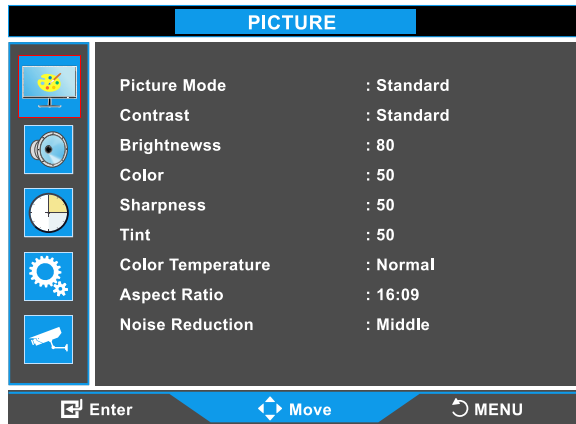

▲/▼ MOVE ◀/▶ SELECT(ADJUST) MENU RETURN

FUNCTION		VALUE
PICTURE MODE	Adjust the image color setting	See table below
CONTRAST	Adjust the contrast	0 ~ 100
BRIGHTNESS	Adjust the brightness	0 ~ 100
COLOR	Adjust the color	0 ~ 100
SHARPNESS	Adjust the sharpness	0 ~ 100
TINT <sup>1)</sup>	Adjust the tint	0 ~ 100
COLOR TEMPERATURE	Adjust the color setting	See table on page 17
ASPECT RATIO	Adjust the video format	See table on page 17
NOISE REDUCTION	Adjust the noise level	OFF / LOW / MIDDLE / HIGH

1) Only available in Composite ( video ) input

PICTURE MODE	
DYNAMIC	Provides enhanced contrast and sharpness
STANDARD	Provides standard contrast and sharpness
MILD	Reduces contrast and sharpness
USER	Applies user selected values - brightness, contrast, color and hue

# CONTROL AND FUNCTION

## Picture

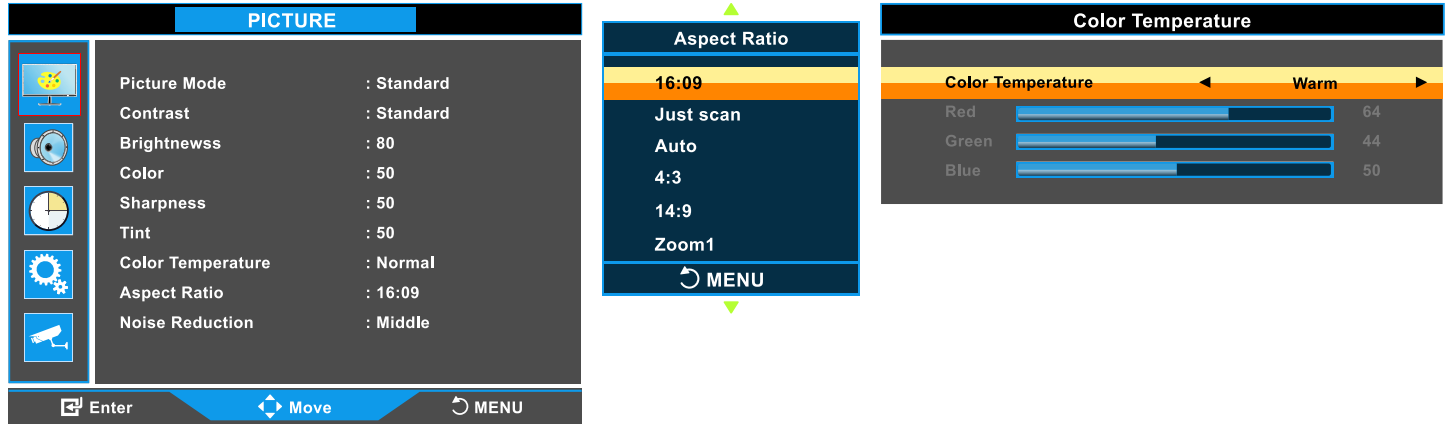

▲/▼ MOVE ◀/▶ SELECT(ADJUST) MENU RETURN

COLOR TEMPERATURE	
WARM	Give the white color a reddish tint
NORMAL	Give the white color a neutral tint
COOL	Give the white color a blue-ish tint

ASPECT RATIO	
16 : 9 <sup>1) 2) 3)</sup>	Sets the image size to 16 : 9
JUST SCAN	Adjusts the image size based on input resolution
4 : 3 <sup>1) 2) 3)</sup>	Sets the image size to 4 : 3
14 : 9	Sets the image size to 14 : 9
ZOOM 1 <sup>3)</sup>	Zooms the image size as factory preset zoom level

1) VGA-input support

2) AV-input support

3) HDMI-input support

# CONTROL AND FUNCTION

## Sound

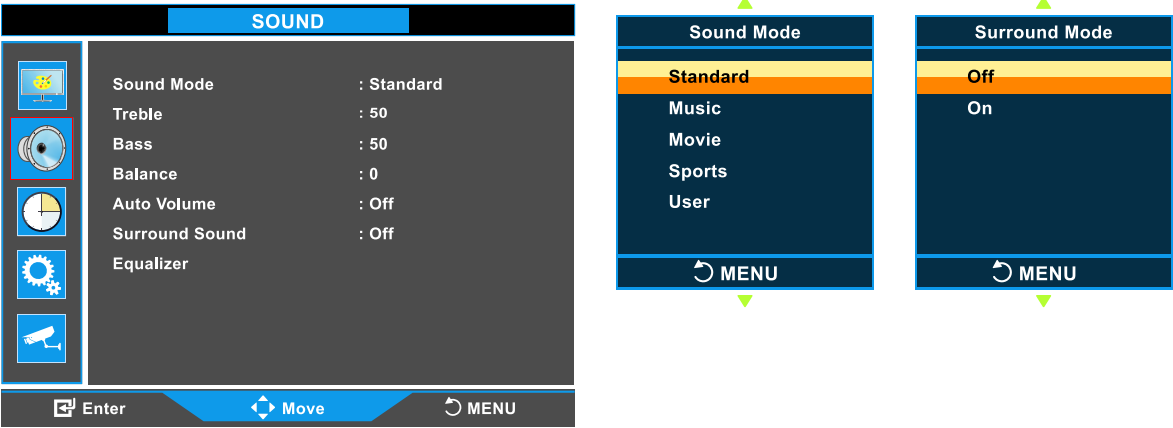

▲/▼ MOVE ◀/▶ SELECT(ADJUST) MENU RETURN

FUNCTION		VALUE
SOUND MODE	Selects one of the presets	STANDARD / MUSIC / MOVIE / SPORTS / USER
TREBLE <sup>1)</sup>	Adjusts the bass level	0 ~ 100
BASS <sup>1)</sup>	Adjusts the bass level	0 ~ 100
BALANCE	Adjusts the balance	0 ~ 100
AUTO VOLUME	Adjusts the volume	0 ~ 100
SURROUND MODE	Adjusts preset sound mode	ON / OFF
EQUALIZER <sup>1)</sup>	Set the equalizer	

1) Only available in USER MODE

# CONTROL AND FUNCTION

## TIME

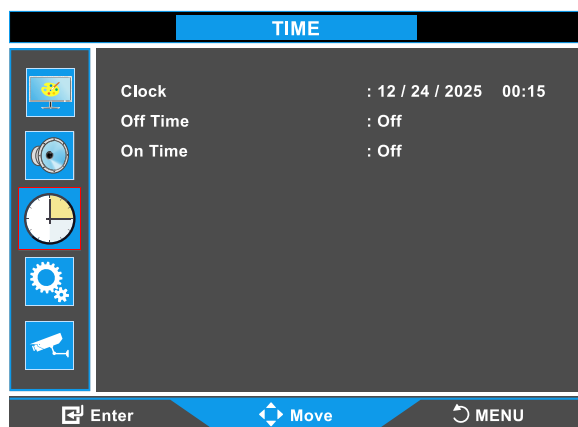

▲/▼ MOVE ◀/▶ SELECT(ADJUST) MENU RETURN

FUNCTION		VALUE
CLOCK	Set the time	Year / Month / Date / Hour / Minute
OFF TIME <sup>1)</sup>	Set the turn-off time	Hour / Minute
ON TIME <sup>1)</sup>	Set the turn-on time	Hour / Minute / Source / Volume

1) Set the schedule as Once, Everyday, Monday through Friday, Monday through Saturday, Saturday through Sunday, Sunday (only)

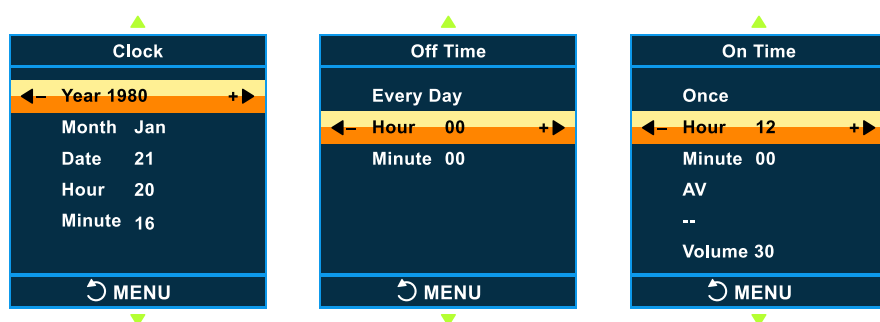

# CONTROL AND FUNCTION

## Option

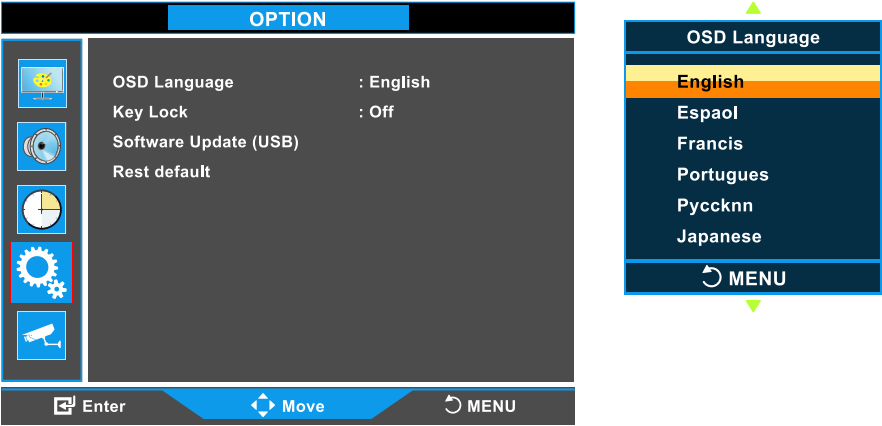

▲/▼ MOVE ◀/▶ SELECT(ADJUST) MENU RETURN

FUNCTION		VALUE
OSD LANGUAGE	Sets the language of the OSD menu	English, Spanish, French Russian, Japanese, Portuguese
KEY LOCK <sup>1)</sup>	Enable / disable the monitor button	On / Off
SOFTWARE UPDATE	Update the system software via USB drive	
RESET DEFAULT	Resets the monitor settings to the factory default	

1) To unlock this mode, press 'MENU' button & hold for 5 seconds - on the monitor. Refer to page 14's monitor buttons.



# CONTROL AND FUNCTION

## Advance - Adjust Recording Indicator Color / Recording Text

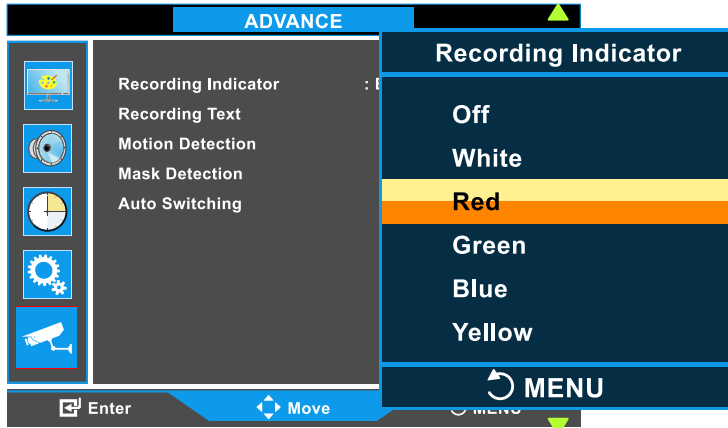

▲/▼ MOVE ◀/▶ SELECT(ADJUST) MENU RETURN

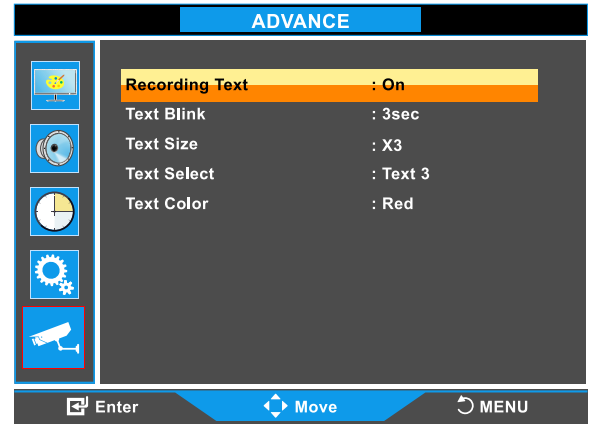

RECORDING TEXT Option Window

	FUNCTION	VALUE
RECORDING INDICATOR	Sets the color of recording indicator LED	OFF / WHITE / RED / GREEN / BLUE / YELLOW
RECORDING TEXT	See table below	
MOTION DETECTION	See table on page 22	
MASK DETECTION	See table on page 23	
AUTO SWITCHING	See table on page 24	

	FUNCTION	VALUE
RECORDING TEXT	Enables the recording text	OFF / ON
TEXT BLINK	Sets the blinking text interval time	OFF / ON / 1 ~ 3 sec
TEXT SIZE	Adjusts the size of text	x 1 / x 2 / x 3
TEXT SELECT <sup>1)</sup>	Selects the preset text	TEXT 1 - <b>RECORDING</b> TEXT 2 - <b>RECORDING IN PROGRESS</b> TEXT 3 - <b>SURVEILLANCE IN PROGRESS</b> TEXT 4 - <b>VIDEO RECORDING IN PROGRESS</b>
TEXT COLOR	Adjusts the color of text	RED / GREEN / BLUE / BLACK / WHITE

1) PRESET TEXT - TEXT 1 : **Recording** / TEXT 2 : **Recording in Progress** / TEXT 3 : **Surveillance in Progress** / TEXT 4 : **Video Recording in Progress**

1) English & Spanish OSD languages are using **PRESET TEXT IMAGE**.

1) French, Russian, Japanese & Portuguese OSD languages are using the **FONT** for **Text 1 ~ 3** and using the **PRESET TEXT IMAGE** for **Text 4**.

# CONTROL AND FUNCTION

## Advance - Adjust Motion Detection

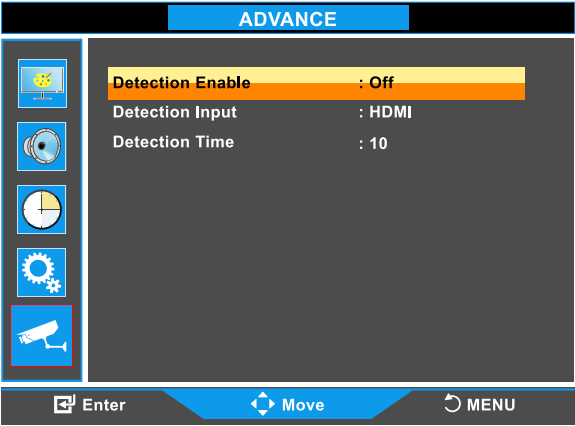

▲/▼ MOVE ◀/▶ SELECT(ADJUST) MENU RETURN

FUNCTION		VALUE
DETECTION ENABLE	Enables the MOTION DETECTION function	OFF / ON
DETECTION INPUT	Selects the input source for Motion Detection	CAMERA / AV / MEDIA / VGA / HDMI
DETECTION TIME	Adjusts the time to display the swapped image / video which is triggered by motion detection. If user selects '10', the monitor will keep showing the swapped image/videos for 10 seconds whether or not motion detected. If there is no motion detection for 10 seconds, monitor will display original image/videos.	3 ~ 100 sec

# CONTROL AND FUNCTION

## Advance - Adjust Mask Detection

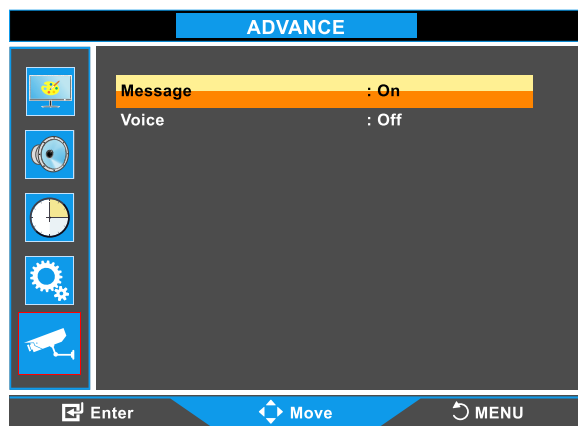

▲/▼ MOVE ◀/▶ SELECT(ADJUST) MENU RETURN

FUNCTION		VALUE
MESSAGE	Enables the MASK DETECTION function and when user enable this function, the monitor will show the 'WEAR MASK' image during detecting an unmasked person.	OFF / ON
VOICE	Enables the MASK DETECTION function and when user enable this function, the monitor will make a sound of 'please wear a mask' during detecting an unmasked person.	OFF / ON

# CONTROL AND FUNCTION

## Advance - Adjust Auto Switching

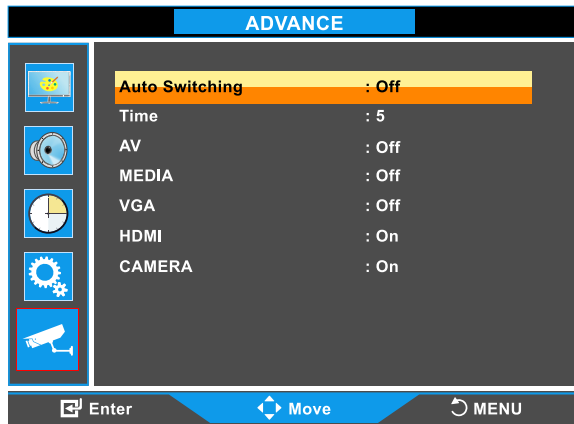

▲/▼ MOVE ◀/▶ SELECT(ADJUST) MENU RETURN

### AUTO SWITCHING Option Window

	FUNCTION	VALUE
AUTO SWITCHING	Enables the AUTO SWITCHING function	OFF / ON
TIME	Adjusts the time which the monitor displays one input source before switching to the other * Only selected two input sources can be displayed	3 ~ 100 sec
AV	Sets the AV input source as the switching display source	OFF / ON
MEDIA	Sets the MEDIA input source as the switching display source	OFF / ON
VGA	Sets the VGA input source as the switching display source	OFF / ON
HDMI	Sets the HDMI input source as the switching display source	OFF / ON
CAMERA	Sets the CAMERA input source as the switching display source	OFF / ON

# CONTROL AND FUNCTION

## Record Camera

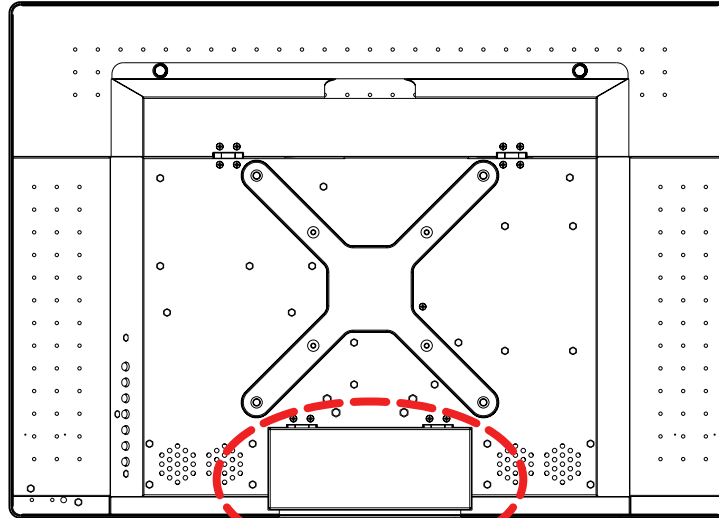

Micro SD Card

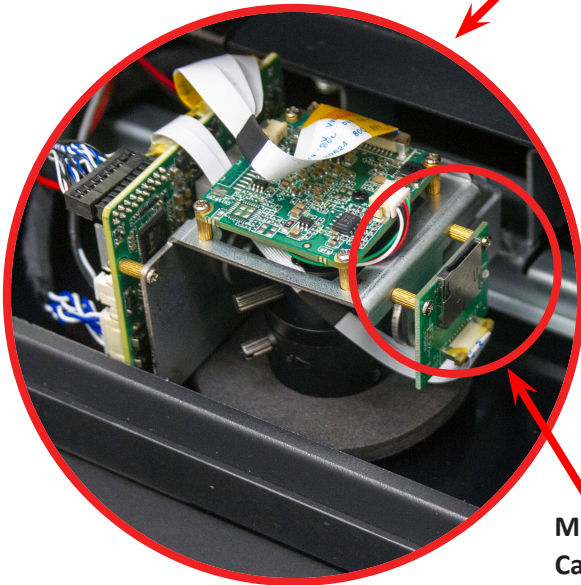

Micro SD  
Card Slot

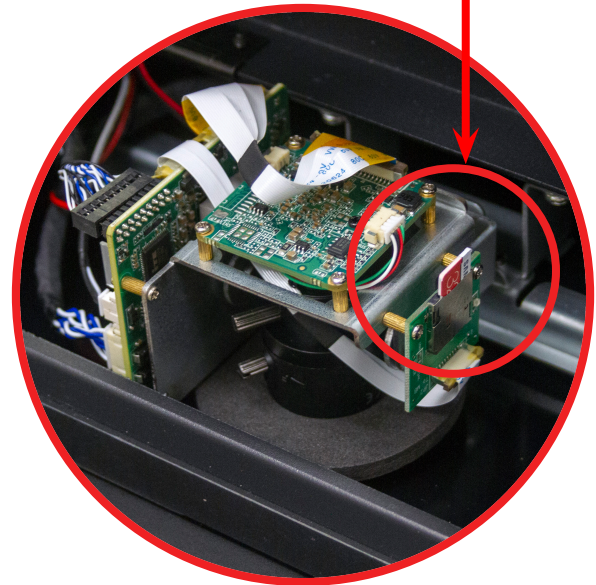

- **Connect Micro SD card**
  1. Open the bottom camera door
  2. Connect Micro SD card to Micro SD Card slot located at the side of PVM camera
  3. To use recording function, please refer the page 88, 89, 89 & 91 of 'VZ-IPPVM-Web-UserManual'
- **Caution** - To use recording function, user should remove every files and format the Micro SD card

# CONTROL AND FUNCTION

## Record Camera

 **Record Policy**

Schedule Record ☐

Alarm Post Record(0-86400s)

Record Rule

Save Days(1-360)

Stream Name

	0	1	2	3	4	5	6	7	8	9	10	11	12	13	14	15	16	17	18	19	20	21	22	23	24
Sun																									
Mon																									
Tues																									
Wed																									
Thur																									
Fri																									
Sat																									

Refresh

Apply

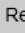
 **Record Path Modify** ×

SD Card ☐

Disk Id

Total Space(MB)

Alarm Threshold(1-100)

Modify

Format

About the detailed feature of recording, please refer **the** page 88, 89, 90 & 91 of '**VZ-IPPVM-Web-UserManual**'

# MOUNTING GUIDE

## Wall Mounting (Optional)

VZ-PVM monitors are suitable for VESA wall mount (not included).

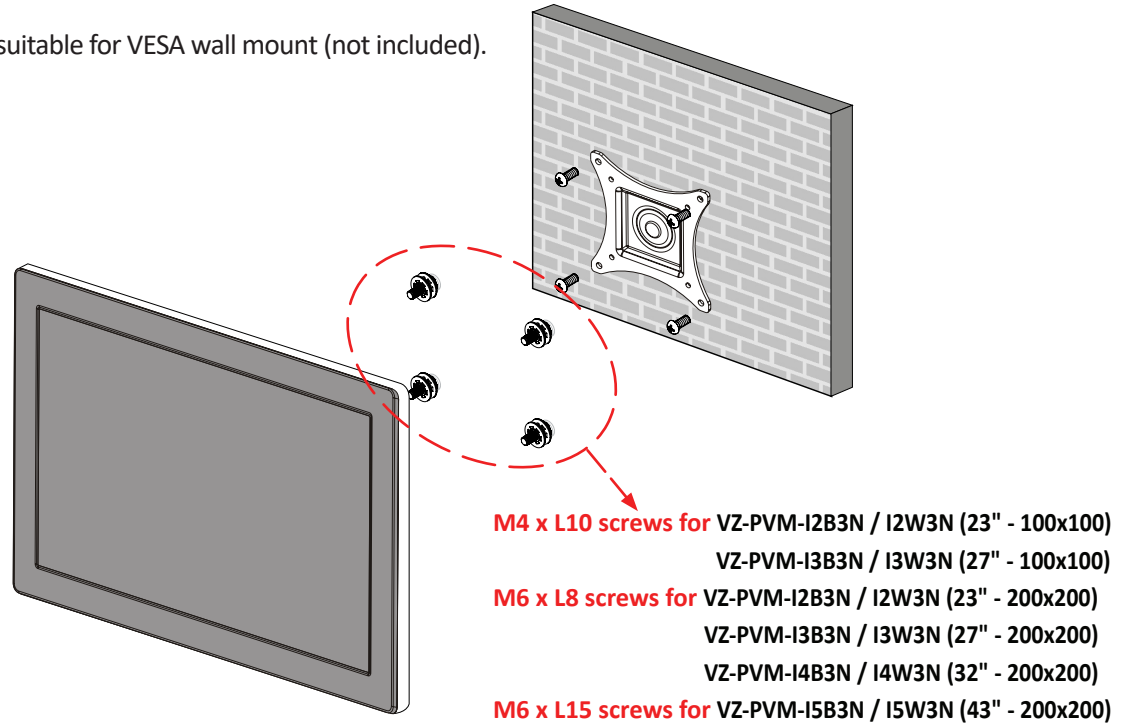

1. VZ-PVM-I2B3N/I2W3N, VZ-PVM-I3B3N/I3W3N : VESA WALL MOUNT 100mm x 100mm, 200mm x 200mm
2. VZ-PVM-I4B3N/I4W3N, VZ-PVM-I5B3N/I5W3N : VESA WALL MOUNT 200mm x 200mm

### ! Attention!

**VZ-PVM-I2B3N/I2W3N (100x100), VZ-PVM-I3B3N/I3W3N (100x100)** : You must use 4 \* M4 x L10 screws to assemble this monitor and the wall mount bracket.

**VZ-PVM-I2B3N/I2W3N (200x200), VZ-PVM-I3B3N/I3W3N (200x200), VZ-PVM-I4B3N/I4W3N** : You must use 4 \* M6 x L8 screws to assemble this monitor and the wall mount bracket.

**VZ-PVM-I5B3N/I5W3N (200x200)** : You must use 4 \* M6 x L15 screws to assemble this monitor and the wall mount bracket.

### ! WARNING !

If user uses screws longer than

M4 x L10 mm for 100 x 100 - VZ-PVM-I2B3N/I2W3N, VZ-PVM-I3B3N/I3W3N

M6 x L8 mm for 200 x 200 - VZ-PVM-I2B3N/I2W3N, VZ-PVM-I3B3N/I3W3N, VZ-PVM-I4B3N/I4W3N

M6 x L15 mm for 200 x 200 - VZ-PVM-I5B3N/I5W3N

it may cause damage to the unit. Please use bolt of correct size and length as instructed.



### Mounting Safety !

At least two people are recommended to safely install the mount.

# SPECIFICATION

Model No.		VZ-PVM-I2B3N / I2W3N	VZ-PVM-I3B3N / I3W3N	VZ-PVM-I4B3N / I4W3N
Size & Type		23.6"	27"	32"
LCD	Panel Type	23.6" LED Backlit Monitor	27" LED Backlit Monitor	32" LED Backlit Monitor
	Pixel Pitch	0.2715 (H) x 0.2715 (V) mm	0.31125 (H) x 0.31125 (V) mm	0.36375 (H) x 0.36375 (V) mm
	Brightness	250 cd/m²	300 cd/m²	250 cd/m²
	Contrast Ratio	3000 : 1(Typ.)	3000 : 1(Typ.)	1200 : 1(Typ.)
	Viewing Angle	R/L : 89°/ 89°    U/D : 89°/ 89°		
	Display Color	16.7 Million Colors		
	Response Time	< 10.0 ms	< 12.0 ms	< 8 ms
	Resolution	1920 (H) x 1080 (V)		
	Active Display Area	521.28(H) x 293.22(V) mm	597.9 (H) x 336.3 (V) mm	698.4 (H) x 392.85 (V) mm
	Aspect Ratio		16 : 9	
Case Type		Metal		
Color Temperature		Warm / Normal / Cool		
Speaker		2 x 5W		
Operating Temperature		32°F ~ 104°F / 0°C ~ 40°C		
Operating Humidity		20 ~ 70% RH		
Weight		Net : 22.04 lb / 10.0 kg Gross : 29.76 lb / 13.5 kg	Net : 28.66 lb / 13.0 kg Gross : 33.06 lb / 15.0 kg	Net : 33.06 lb / 15.0 kg Gross : 39.68 lb / 18.0 kg
INTERFACE		COMPOSITE VIDEO IN x 1, HDMI (High Definition Multimedia Interface) IN x 1, VGA (RGB-PC) IN x 1, CAMERA OUT ( RJ-45 x 1 (PoE), CVBS x 1), Micro SD IN x 1, Audio IN / OUT x 1 / 1		
Safety & EMC Certification		CE / FCC / NDAA / ROHS		
Electrical Ratings	PoE IN	PoE ++ (Type 3) 48V DC		PoE ++ (Type 4) 48V DC
	DC 24V IN	24V DC (AC110V-240V (with DC adaptor))		
		24V $\equiv$ 2.7A	24V $\equiv$ 3.0A	24V $\equiv$ 3.0A
Power Consumption		≤ 50 W	≤ 50 W	≤ 65 W
Accessories		DC 24V Power Adapter, DC 24V Connector (Pig Tale), Power Cable, Quick Reference Guide, SW/Manual CD, Remote controller		



# SPECIFICATION

Model No.		VZ-PVM-I5B3N / I5W3N
Size & Type		43"
LCD	Panel Type	43" LED Backlit Monitor
	Pixel Pitch	0.4902 (H) x 0.4902 (V) mm
	Brightness	350 cd/m <sup>2</sup>
	Contrast Ratio	1200 : 1(Typ.)
	Viewing Angle	R/L : 89° / 89° U/D : 89° / 89°
	Display Color	16.7 Million Colors
	Response Time	< 8.0 ms
	Resolution	1920 (H) x 1080 (V)
	Active Display Area	944.0 (H) x 532.0 (V) mm
	Aspect Ratio	16 : 9
Case Type		Metal
Color Temperature		Warm / Normal / Cool
Speaker		2 x 5W
Operating Temperature		32°F ~ 104°F / 0°C ~ 40°C
Operating Humidity		20 ~ 70% RH
Weight		Net : 50.7 lb / 23.0 kg
		Gross : 61.7 lb / 28.0 kg
INTERFACE		COMPOSITE VIDEO IN x 1, HDMI (High Definition Multimedia Interface) IN x 1, VGA (RGB-PC) IN x 1, CAMERA OUT ( RJ-45 x 1, CVBS x 1), Micro SD IN x 1, Audio IN / OUT x 1 / 1
Safety & EMC Certification		CE / FCC / NDAA / ROHS
Electrical Ratings	AC IN	AC 110-240V, 50/60Hz
	DC 24V IN	24V $\overline{=}$ 5.0 A
Power Consumption		≤ 85 W
Accessories		HDMI cable, DC 24V Connector, Quick Reference Guide, Power Cable, SW/Manual CD, Remote controller

# SPECIFICATION

## Camera Specification

	Parameters	Description
Production Information	Product Name	2MP IP module
Main Chipset	Encode Chipset	NT98520
	Sensor	SONY IMX307
Camera	Resolution	1920 (W) x 1080(H)
	Video System	NTSC / PAL
	Digital Zoom	Support
	Minimum illumination	Color: 0.01 Lux@ (F1.2, AGC ON) / B&W: 0.0 Lux@ (IR LED ON)
	Day & Night Mode	Support - Auto (ICR)
	Electronic Shutter Speed	Auto/Manual, 1/5 ~ 1/20,000s
	S/N Ratio	55dB
Lens	Wide Dynamic Range (WDR)	True WDR
	Lens Type	Vari-Focal
	Focal Length of the Lens	2.7 ~ 12 mm
External interface	Auto Iris	Support
	Network Interface	RJ45 10 /100 Base-T
	CVBS Output	Support
	Reset Button	Support
Video	Edge Storage	Built-in Micro SD slot, up to 256G
	Video Encode	H.264 (Main profile), H.265, MJPEG
	Multi-Stream	Main stream ,2 <sup>nd</sup> stream, 3 <sup>rd</sup> stream
	Video Resolution and Frame Rate	NTSC 60Hz:30fps / PAL 50Hz:25fps
		Main stream: 1920*1080 @ 25/30fps   1280*720 @ 25/30fps
		2 <sup>nd</sup> stream: D1, VGA, 640×360, CIF, QVGA @ 25/30fps
		3 <sup>rd</sup> stream: VGA, CIF, QVGA @ 25/30fps
	Video Bit Rate Control	1Mbps-8Mbps,support CBR/VBR
	Video Bit Rate	Main stream: 100kbps ~ 12Mbps
		2 <sup>nd</sup> stream: 10kbps ~ 6Mbps
		3 <sup>rd</sup> stream: 10kbps ~ 3Mbps
	Image Enhancement	Support HLC / BLC / Defog / WDR
	White Balance	Auto
	Gain Control	Auto / Manual
	Noise Reduction	2D/3D DNR
	Aisle Mode	Support
	Smart IR	Support
	Mirror	Support
	Region of Interest	Off/On (8 Zone, Rectangle)
	Motion Detection	Support
	Privacy Masking	Support

# SPECIFICATION

## Camera Specification

	Parameters	Description
Smart Function	Mask Detection	Support
	Intelligent Detection	Perimeter, Single Virtual Fence, Loiter, Converse, Double Virtual Fences, Signal Bad
Network	Integration Protocol	ONVIF 2.6 (supported), SDK, CGI
	Network Protocol	IPv4/IPv6, 802.1x, HTTP, HTTPS, TCP/IP, UDP/IP, RTSP, DHCP, NTP, RTCP/RTP, PPPoE, SMTP, DNS, UPnP, FTP, ARP, SNMP, TLS/SSL
	Streaming Mode	Unicast
	Concurrent Access (# of Users)	10 users ( Maximum 3ch 1080P )
	User Rights	Two roles: administrator and common users. The administrator can assign common users different rights.
WEB application	Language	English default
	Browser	Windows IE 11 / Edge / Firefox / Chrome
Recording Capacity		TF Card (EXT4 format, MAX256G)
	2MP - H.265 w/256G	30fps(11days) / 15fps(15days)
	2MP - H.264 w/256G	30fps(5days) / 15fps / 7days

## Media Player Specification

	Description
External Storage	Support SD/SDHC CARD (Max 128GB), USB 2.0 HOST
VIDEO Format	RM,RMVB(RV30/RV40), VOB(MPEG-2), HDMOV, AVI(DviX, Xvid, MJPEG;MPEG-4 SP/ASP, H.264), DVIX, MPG (MPEG-1, MPEG-2), M4V, PMP, AVC, FLV, MP4 (MPEG-4 SP/ASP, H.264/H.263; Motion JPEG; H.265(720P)), DAT(MPEG-1), MPEG, MOV/MKV(MPEG-4 SP/ASP, H.264/H.263), TS (MPEG-2, H.264, Avs, Avs+), M2TS, WMV, H.264, H.263, WMV9, VC-1, MPEG1/2/4
Output	VIDEO - HDMI(1080p) / AUDIO - L/R, HDMI
VIDEO Resolution	1080P @60Hz
AUDIO Format	MPEG1/2/4, MP3, WMA, OGG, AAC, FLAC, APE, AC-3, DTS, ATRA, WAV, PCM
IMAGE Format	JPEG, JPG, PNG, BMP
VIDEO Play Control	AUTO, REPEAT, ZOOM, RESUME, TIME

# TROUBLESHOOTING GUIDE

- Check the following before calling for service.
- If the same problems continue after checking, contact the reseller you purchased the monitor from.

At start	We recommend that you test with different input sources when you have trouble with the current input source. If symptom persists, follow the instructions below. After following the instructions below, please contact us at 1-888-99-VIEWZ.
No image or Noise on the screen	<ul style="list-style-type: none"> <li>- Make sure the power cable is correctly plugged into the outlet</li> <li>- Make sure the power cable is correctly plugged into the monitor</li> <li>- Make sure the cable is correctly connected between monitor &amp; source</li> <li>- Check brightness and see if brightness is set to 'Ø'</li> <li>- Check video source</li> </ul>
Incorrect display or Half display	<ul style="list-style-type: none"> <li>- Check your video source</li> <li>- Reset video source : connection, cable replacement, setting &amp; more</li> </ul>
Flickering and shadow image	<ul style="list-style-type: none"> <li>- Check your input source setting for resolution and phase (Hz)</li> </ul>
The audio function is not working	<ul style="list-style-type: none"> <li>- Check the volume and make sure MUTE is not on</li> <li>- Check HDMI / Audio port cable connection</li> </ul>
LED is flickering or no image	<ul style="list-style-type: none"> <li>- Check the interface cable connection and make sure it's plugged in correctly</li> <li>- Check the input source</li> </ul>

# TERMS OF WARRANTY / RMA

- The warranty period for this monitor is 3 years. The warranty will be voided for the scenarios listed below.
- You can also download the manual and information at VIEWZ web site: [VIEWZUSA.COM](http://VIEWZUSA.COM)

Cases of Non-Warranty Coverage	When power feed to the monitor exceeds capacity and causes damage
	Accident, Abuse, Misuse, Neglect, Fire, Water/liquids, Lightning or any act of nature
	Damaged by dropping, throwing and hitting the monitor
	Failure caused by users attempt to modify the product
	Failure by limited life of parts such as LED Lamps and any other consumables
	Damaged by using third party power cable, unstable power input and electric shock

\* Above information can be changed without notification - please check our website or contact ViewZ representative for latest RMA service policy.

\* When shipping the monitor for RMA, make sure to pack safely to ensure the monitor is not damaged during shipping.

## This image shows a single sheet of white paper with horizontal blue or grey ruling lines. The lines are evenly spaced and run across the width of the page. There are no margins, text, or other markings on the paper.

## NOTE

This image shows a single sheet of white paper with horizontal ruling lines. The lines are evenly spaced and run across the width of the page. There are no margins, text, or other markings on the paper.

# WARRANTY

## ViewZ USA LIMITED 3 YEAR WARRANTY

### What and Who is Covered by this Limited Warranty and for How Long

ViewZ USA warrants this product to be free from defects in material and workmanship for 3 years to the original owner of this product. The limited warranty is valid only for the original purchaser of the product.

### What ViewZ USA Will Do

At the sole discretion of ViewZ USA, ViewZ USA will repair or replace any product or product part that is defective. If ViewZ USA chooses to replace a defective product or part, a replacement product or part will be shipped to you at no charge, but you must pay any labor costs.

### What is Not Covered; Limitations

ViewZ USA disclaims any liability for damage to mounts, adapters, displays, projectors, other property, or personal injury resulting, in whole or in part, from improper installation, modification, use or misuse of its products.

ViewZ USA disclaims all other warranties, express or implied, including warranties of merchantability and fitness for a particular purpose. ViewZ USA is not responsible for incidental or consequential damages, including but not limited to, inability to use its products or labor costs for removing and replacing defective products or parts. Some states do not allow the exclusion or limitation of incidental or consequential damage, so the above limitation or exclusion may not apply to you.

### What Customers Must Do for Limited Warranty Service

If you discover a problem that you think may be covered by the warranty you MUST REPORT it in writing to the address below within thirty (30) days. Proof of purchase (an original sales receipt) from the original consumer purchaser must accompany all warranty claims. Warranty claims must also include a description of the problem, the purchaser's name, address, and telephone number. General inquiries can be addressed to ViewZ USA Customer Service at 1-888-998-4399. Warranty claims will not be accepted over the phone or by fax.

ViewZ USA  
Attn: Warranty Claim  
1030 N ARMANDO ST.,  
ANAHEIM, CA 92806

### How State Law Applies

This warranty gives you specific legal rights, and you may also have other rights which vary from state to state.

### Disclaimer

ViewZ USA intends to make this manual accurate and complete. However, ViewZ USA makes no claim that the information contained herein covers all details, conditions or variations, nor does it provide for every possible contingency in connection with the installation or use of this monitor. The information contained in this document is subject to change without notice or obligation of any kind. ViewZ USA makes no representation of warranty, expressed or implied, regarding the information contained herein. ViewZ USA assumes no responsibility for accuracy, completeness or sufficiency of the information contained in this document.

### Contact Us

**NORTH AMERICA**  
1030 N ARMANDO ST.,  
ANAHEIM, CA 92806  
USA and Canada  
Phone: 1-888-998-4399  
Fax: 1-714-996-1138  
Other Locations  
Phone: (001) 888-998-4399  
Fax: (001) 714-996-1138

© ViewZ USA