

SPECIFICATIONS

Focal Length	6.5 - 39 mm
Maximum Relative Aperture	1:1.0
Iris	F1.0 - Approx. 1200 (With ND Spot Filter)
Zoom Ratio	6 X
Angular Field of View	40.5° x 30.9° at 6.5 mm 7.0° x 5.3° at 39 mm
Image Format	4.8 x 3.6 mm (Ø6 mm)
Minimum Object Distance	1.0 m (From Front Vertex)
Object Dimensions at M.O.D.	73.8 x 55.3cm at 6.5 mm 12.2 x 9.3cm at 39 mm
Optical Back Focal Distance	11.76 mm (In Air)
Flange Back	12.5 mm
Input Signal	Composite Video Signal, Video Signal
Sensitivity Adjustment	0.5 ~ 1.0Vp-p (Image Signal)

Photometry Range	Approx. 40% - 70% Variable to Vp-p
Input Impedance	High Impedance
Operation	Zoom Motorized (DC +/- 6.4V, Max 40mA) Speed Approx. 6sec. Focus Motorized (DC +/- 6.4V, Max 40mA) Speed Approx. 7sec. Iris EE (DC+8.5 to 16V : Fixed Voltage, Max 60mA)
EE Mechanism	The built-in EE Amp amplifies the difference between the video signal from the camera and the preset Iris signal level. It causes the Iris to change size.
Operation Temperature	- 10 °C ~ 50 °C / 14 °F ~ 122 °F
Mount	CS-Mount (Adjustable Lens Position)
Front Thread	52 mm P0.75
Size, Weight	70(W) x 60(H) x 98.9(D) mm, Approx. 500g

DIMENSIONS

UNIT: mm

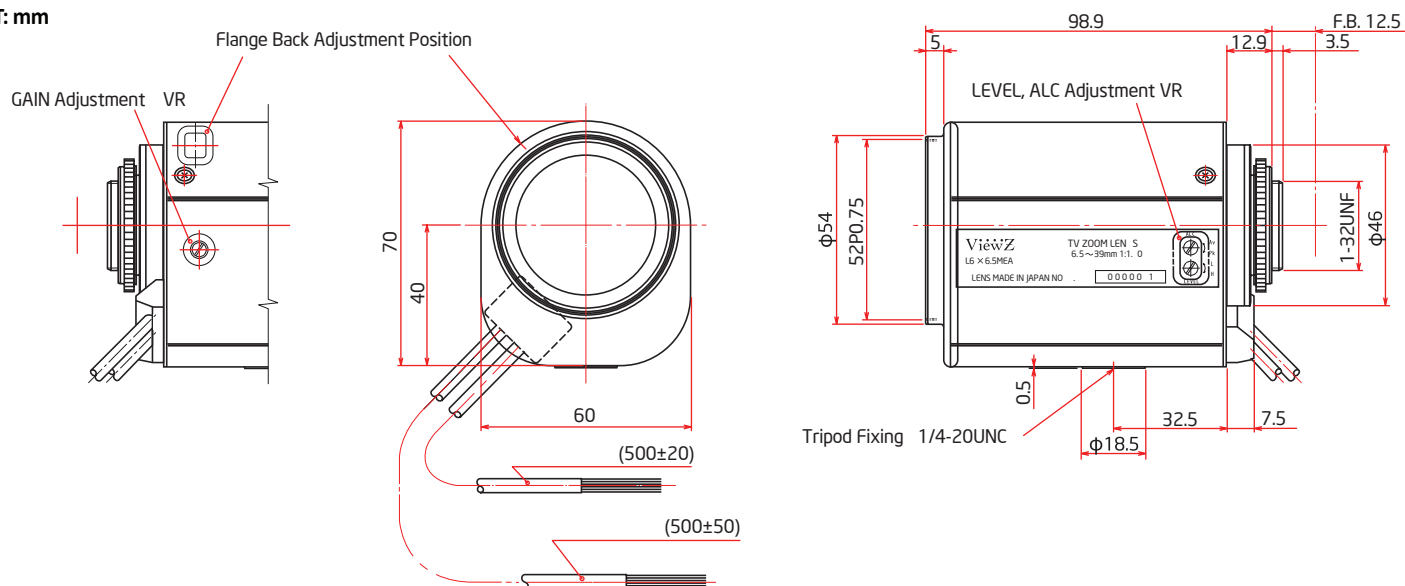

CIRCUIT DIAGRAM

