

7" PORTABLE FIELD 3G-SDI MONITOR

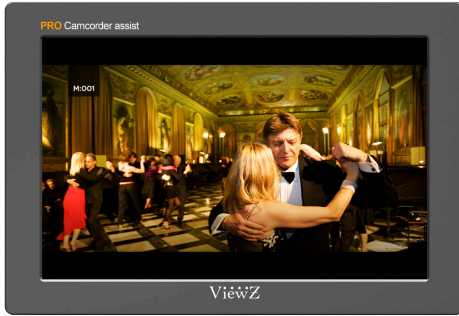

3-Gbps (3G)-SDI, higher resolution (FHD) of picture quality required Serial Digital Interface (SDI) for 1080p/60Hz.



Wider color gamut range to make precise color reproduction of Rec.709 color space with built-in 3D LUT, featuring 8 default logs & 6 user logs.



Display the RGB of the input video signal as a form of waves



Display an X-Y plot of two signals, revealing the detailed relationship between two signals. On screen display of chrominance information in Cb and Cr channels. Display can be opaque or solid against the visual display



The HDMI output connector can actively transmit in HDMI input signal or output in HDMI signal that has been converted from an SDI signal. In short, signal transmits from SDI input to HDMI output & from HDMI input to SDI output.



VZ-070FM-HDR has a 1920x1080 resolution & use 7" IPS panel with wide viewing angles



The HDR let the display reproduce a greater dynamic range of luminosity, allowing lighter & darker details to be displayed clearly. Effective enhancing the overall picture quality. VZ-070FM-HDR supports Gamma 1.8, 2.0, 2.2, 2.35, 2.4, 2.6, 2.8



VZ-070FM-HDR matches with world-famous 4K/FHD camera brands to assist field camera in better experience. VZ-070FM-HDR supports the color space of Native/SMPTC-C/Rec. 709/EBU.

VZ-070FM-HDR ADVANTAGES

- 7" IPS 1920x1200 Resolution, 3D-LUT - 8 Default Logs & 6 User Logs
- SDI to HDMI Cross Conversion, HDR (PQ / HLG) Supported
- SDI (1080p) / HDMI Inputs and loop through
- Gamma 1.8, 2.0, 2.2, 2.35, 2.4, 2.6, 2.8 | RGB Gain | Check Field
- Waveform, Vector Scope, Time Code, Marker, Image Flip, Peaking
- Audio Level Indicators, Scan, Underscan, Freeze, H/V Delay, DSLR
- False Color, Exposure, Histogram, Optional Color Calibration Tool

MODEL #		VZ-070FM-HDR
DISPLAY		
Screen Size	7" (IPS Panel)	
Max. Resolution	1920 x 1080 pixel	
Pixel Pitch	0.039 mm x 0.117 mm	
Brightness	500 cd/m ² (Typical)	
Contrast Ratio	1000 : 1	
Aspect Ratio	16 : 10	
Viewing Angle (H/V)	170° / 170°	
Color Depth	16.7 M (8bit)	
INTERFACE		
3G-SDI In / Out	1 / 1	
HDMI In / Out	1 / 1	
USB (3D-LUT load)	1	
Audio Out	1 / 1	
AUDIO		
Built in speaker	1W x 1	
DIMENSIONS & WEIGHT - WITH MOUNT		
Outline Dimension (W x H x D)	7.16 x 4.88 x 0.86" / 182 x 124 x 22 mm	
Net Weight	0.89bs (405g)	
Input Format		
SDI	SMPTE 425M-AB	1080p / 60,59.94,50
	SMPTE 372M	1080p / 30,29.97,25,24,23.98
		1080i / 29.97,25,24,23.98
		720p / 60,59.94,50
	SMPTE 296M	720p / 60,59.94,50,30,29,25,24,23.98
	SMPTE 292M	1080p / 30,29.97,25,24,24sf,23.98, 23.98sf
SMPTE 274M	1080p / 30,29.97,25,24,24sf,23.98, 23.98sf	
SMPTE 125M	480i / 59.94	
	ITU-R BT.656	576i / 50
		1080i / 60,59.94,50
HDMI	1080p, 1080i, 720p, 576p, 576i, 480p, 486i	
GENERAL		
Power	- Electrical Ratings	DC 7 ~ 24V / 1A
	- Consumption	≤ 12 W
Warranty	2 Years	
Operating Temperature Humidity	-4 ~ 140°F / -20 ~ 60°C 90% RH	
Storage Temperature	-22 ~ 158°F / -30 ~ 70°C	
Package Include	Monitor x1, Hood x1, 12V DC Adapter x1, HDMI A/C Cable x1, Shoe Mount x1, VESA battery Plate x1, V-Mount x1, Battery Plate (QM91D, DU21, F9870, LPE6) x 2, Battery Plate Bracket x1, Manual x1, Battery x1, Auto Bauer Mount x1	

DIMENSION

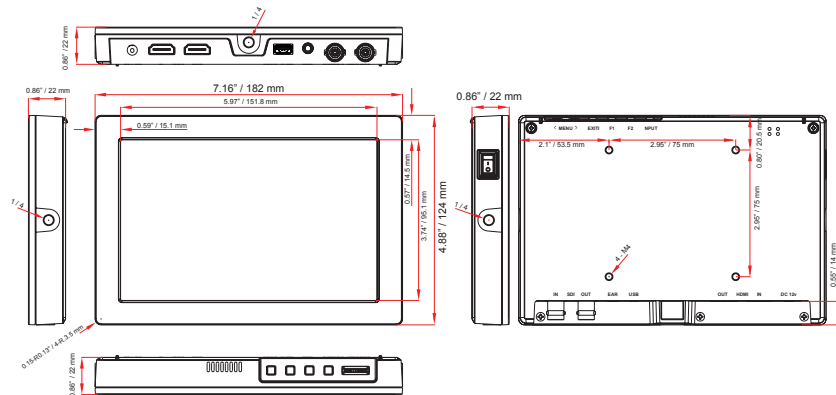

INTERFACE

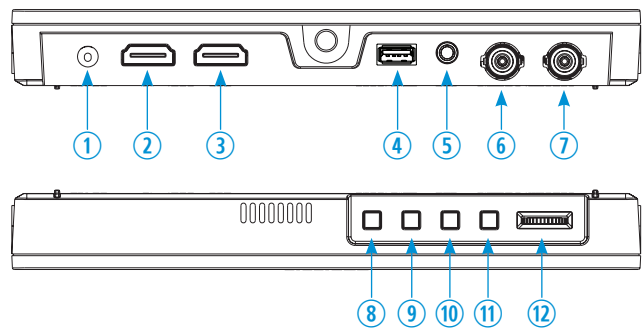

- | | | |
|-----------------|--------------|--------------|
| 1. DC 12 V In | 6. SDI Out | 11. Exit Btn |
| 2. HDMI In | 7. SDI In | 12. Menu Btn |
| 3. HDMI Out | 8. Input Btn | |
| 4. USB | 9. F2 Btn | |
| 5. AV Audio Out | 10. F1 Btn | |

Contact ViewZ

- Address : 177 W. Orangethorpe Ave., Placentia, CA 92870
- Phone : (714)996-1177, Fax : (714)996-1138
- Sales : sales@viewzusa.com
- Specification subject to change without notice.