

## SPRING LOADED SCISSOR VIDEO WALL MOUNT

### VZ-XMS ADVANTAGES

The ViewZ **XMS** mount is a customizable CCTV video wall extending flat-panel mount for displays weighing up to 154 lb. 70 kg with a mounting pattern of 200 x 200 to 800 x 400 mm. It features multi-monitor stacking, **open design**, **custom spacers**, top **adjustable mounting brackets** and **straight scissor-style extension**.

- Pop-out Landscape CCTV Video Wall Mount
- Pop-out extension easily pulls out for installation and maintenance
- Spring loaded and X, Y and Z axis fine tune adjustment system for easy and accurate installation
- Quick-release latch easily activates lock & unlock mode to secure displays in place firmly
- Anti-theft design offers an additional insurance against theft (a padlock required)
- Scissor design and compact mounting arms allow for extension in one smooth motion
- “Click-it” locking feature confirms display is secure through an audible noise

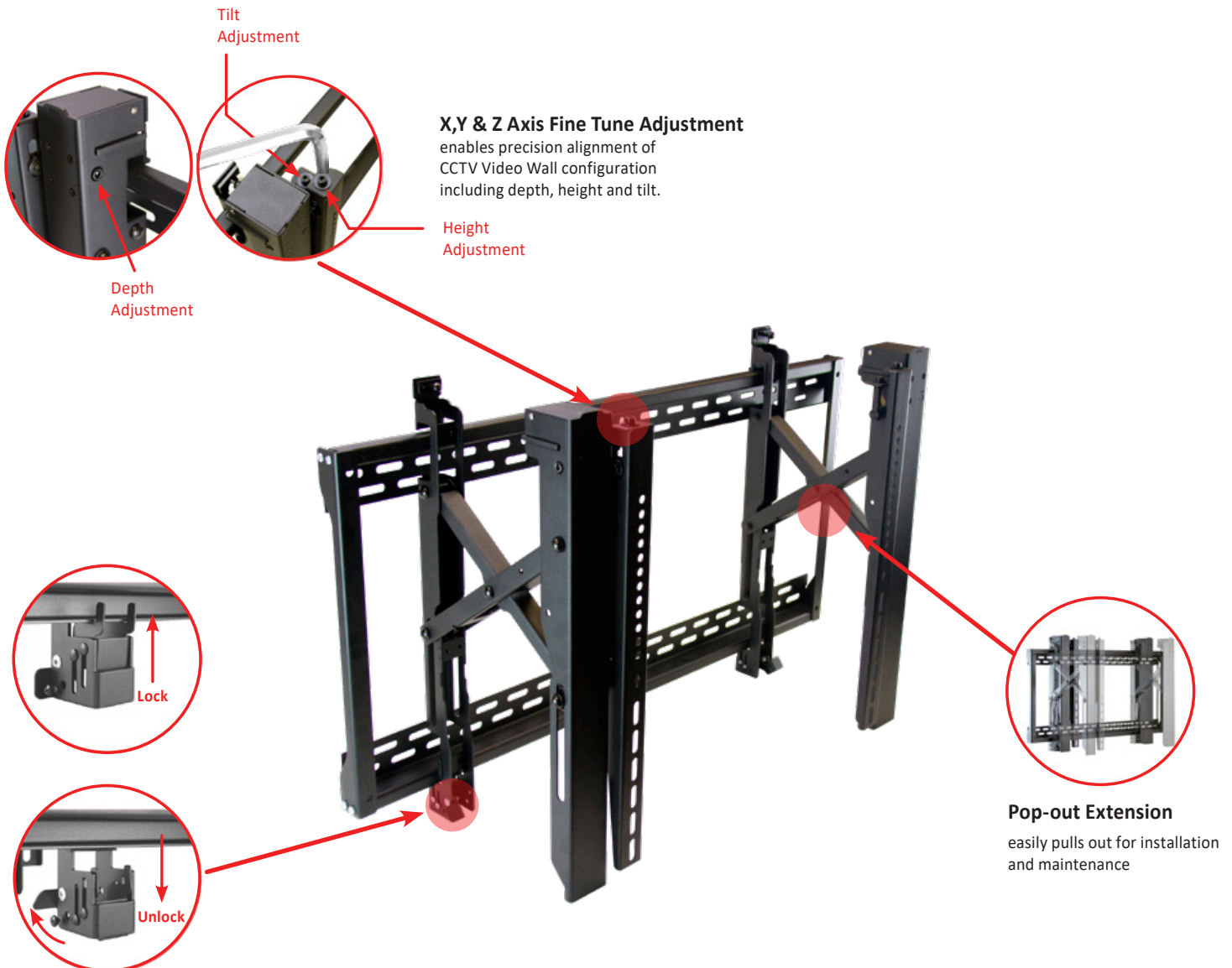

#### Quick Release Latch

easily activates lock & unlock mode to secure monitors in the position

## SPRING LOADED SCISSOR VIDEO WALL MOUNT

### SPECIFICATION

MODEL # VZ-XMS	SPECIFICATIONS
Weight Capacity per Head	154 lbs / 70 Kg
Display Range	43.0" ~ 65.0"
Mounting Patterns	200 x 200 (Min) ~ 800 x 400 (Max) mm
Mounting Patterns Type	Range
Tilt	- 2° ~ +4° (Ver) / ± 3° (Hor)
Height Adjustment	25 mm
Depth Adjustment	20 mm
	WEIGHT & DIMENSIONS
Dimensions ( W x H x D )/ unit: inch	44.64 x 19.01 x 3.74 ~ 11.22
Dimensions ( W x H x D )/ unit: inch	1134 x 519 x 95 ~ 285
DIM Dimensions ( W x H x D )/ unit: inch	34.25 x 16.33 x 1.29
DIM Dimensions ( W x H x D )/ unit: inch	870 x 415 x 33
Net Weight	25.0 lbs / 11.33 Kg

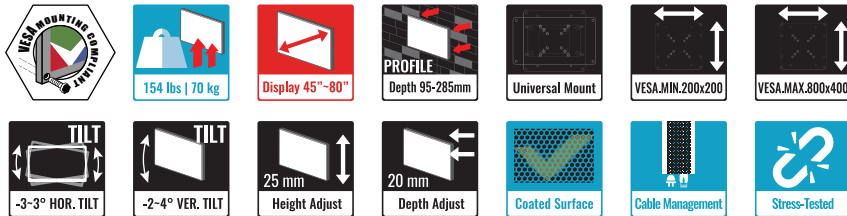

### Designed specifically for

VZ-49/55 UNBS

VZ-55 EHB/ENB

VZ-55 SHB/SNB

VZ-43/55/65 UHD

VZ-43 CMP

### Option

The ViewZ **XMS-SP** mount spacer is built for VZ-XMS series, when make up of ViewZ 49" & 55" video wall monitor. VZ-XMS-SP use lock-screws to make up the perfect videowall spacing.

- Working with ViewZ XMS mount
- Using lock screws to make up the perfect spacing between mounts

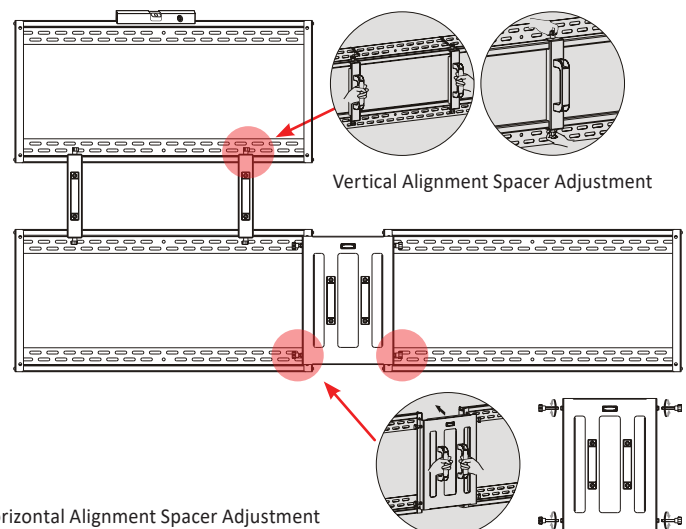
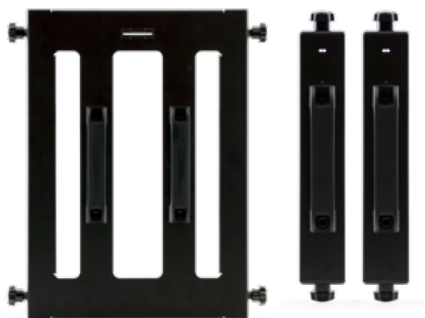

# VZ-XMS

**ViewZ**<sup>®</sup>  
DRIVING VISUAL INNOVATION

## SPRING LOADED SCISSOR VIDEO WALL MOUNT

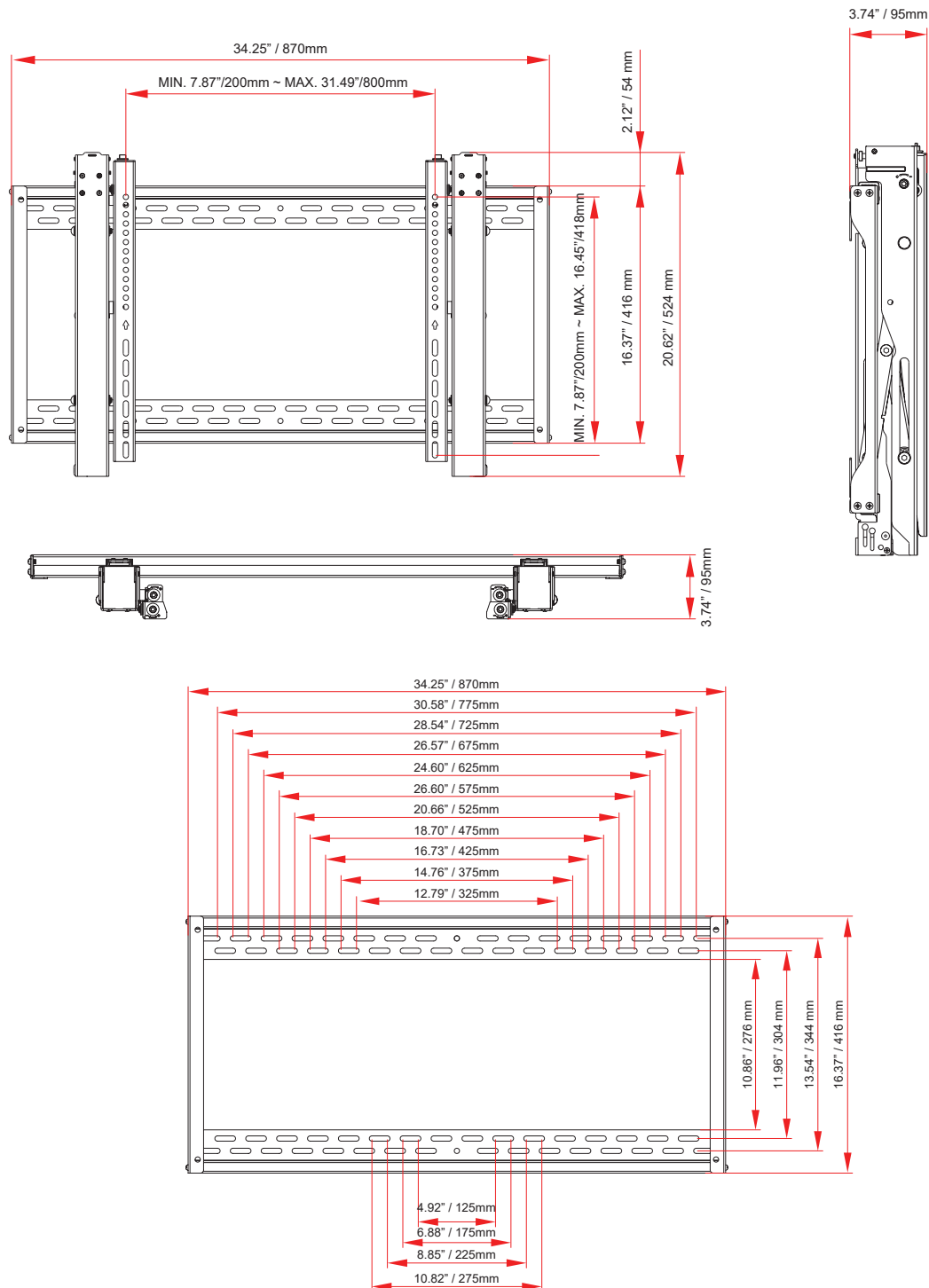

ViewZ and identifying product names and numbers herein are registered trademarks of ViewZ. All non-ViewZ brands and product names are trademarks or registered trademarks of their respective companies. Product appearance, build status, and/or specifications are subject to change without notice.

Copyright © ViewZ. All rights reserved.

\* Availability of product may vary by country / region.

\* Product specifications in this brochure can change. Please confirm details on our website.

- Address : 177 W. Orangethorpe Ave., Placentia, CA 92870
- Phone : (714) 996-1177, Fax : (714) 996-1138
- Sales : sales@viewzusa.com