

VZ-CM-P15 ADVANTAGES

- 1 - 1/2" NPT Standard Pipe Thread
- Powder-Coated Surface
- Fast and Easy installation
- Adjustable length Min. 8.7" ~ Max. 14.55" (220mm ~ 370mm)
- 2-3 units of VZ-CM-P15 poles can be connected by using VZ-CM-C Pole connector.

Connecting more than 3 poles is not recommended.

Designed specifically for

VZ-CM-C Extension Column Connector

VZ-CM-T Tilt Ceiling Plate

VZ-CM-V1 23"-43" VESA Mounting Head

VZ-CM-V3 43"-65" Universal Mounting Head

FEATURES



1-1/2" Standard Pipe Thread

1-1/2" Standard Pipe Thread

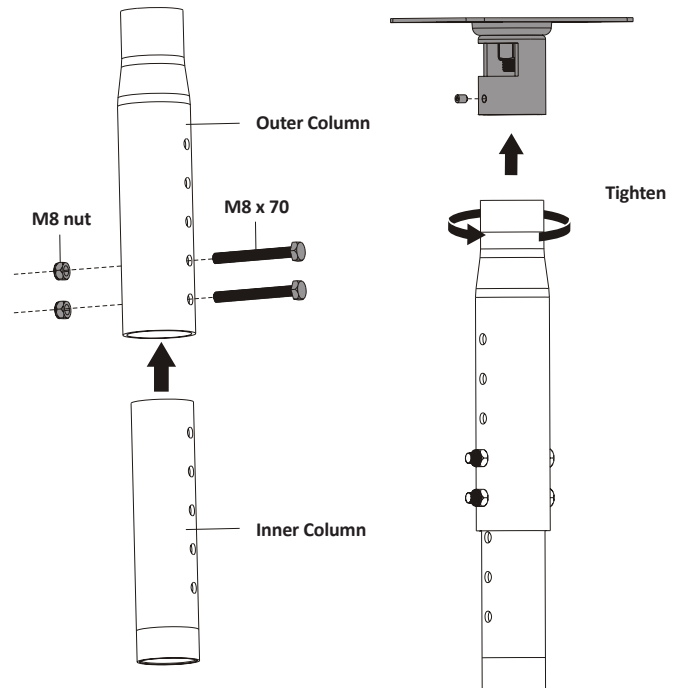

MODEL #	VZ-CM-P15
FEATURES	
Net Weight	2.11 lbs / 0.96 kg
Weight Capacity	110 lbs / 50 kg
Pole (R x Length)	Ø 59 x 280-370 mm / Ø 2.32 x 8.7 - 14.55"
Thread	Ø 38.1 mm / 1-1/2"

Contact ViewZ

- Address : 1030 N ARMANDO ST., ANAHEIM, CA 92806
- Phone : (714) 996-1177, Fax : (714) 996-1138
- Sales : sales@viewzusa.com

DIMENSIONS

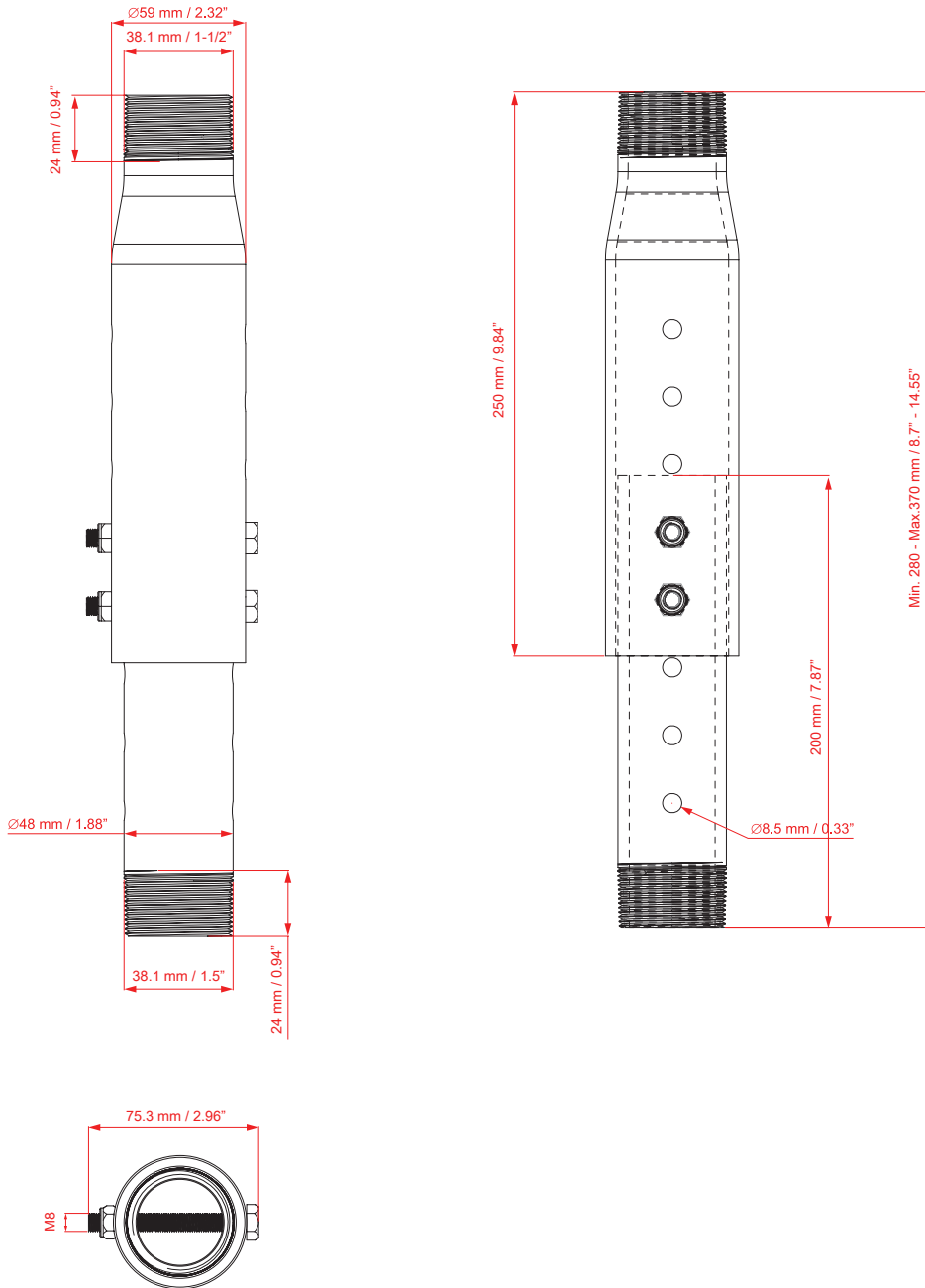

Contact ViewZ

- Address : 1030 N ARMANDO ST., ANAHEIM, CA 92806
- Phone : (714) 996-1177, Fax : (714) 996-1138
- Sales : sales@viewzusa.com