

VZ-IP-PVMN SERIES

23", 27" & 32" IP PUBLIC VIEW MONITOR

MEDIA CARD USER MANUAL



ViewZ®
www.viewzusa.com

Please read this manual thoroughly before use, and keep it handy for future reference.

REMOTE FUNCTION

Remote Controller

Media Controller

1. **Source** - To enter / exit Media player OSD, select the 'Media' on the input source list
2. **Menu** - Enter / Exit Media player menu
3. **Exit** - Exit Media player menu
4. **Left & Right** ◀(VOL)▶, **Up & Down** ▲▼
5. **Enter** - Confirm the selection
6. **Stop & Play** - Freeze the media play
7. **Stop** - Stop the media play

* Input source list window will show on the top-left corner. Select 'MEDIA.'

VGA
HDMI
CAMERA
AV
MEDIA

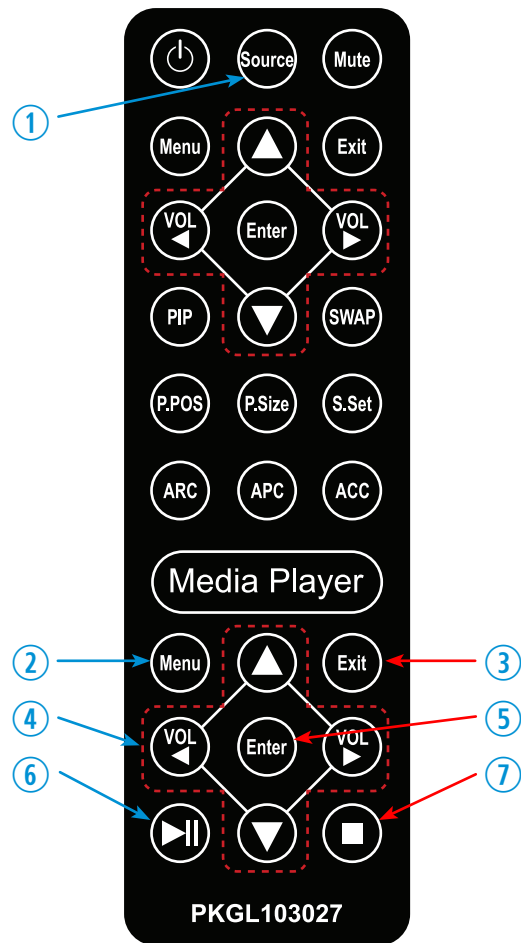

Display image, sound, videos and custom settings can be adjusted in Media player OSD (On Screen Display) menu by remote controller. To adjust, play and stop media :

1. When select '**MEDIA**' among the input source list, press the '**MENU**' button to enter the Media OSD
2. Press the ◀ / ▶ buttons to select the desired sub-menu. The selected submenu will be highlighted
3. Press the '**ENTER**' button to enter the sub-menu for playing or adjusting setup
4. Press the ◀ / ▶ / ▲ / ▼ buttons to select a file to play. Press '**ENTER**' button to play selected content.
5. Press the '**STOP**' button to stop playing.
6. Press the '**EXIT**' button to exit to the Media OSD
7. Press the '**SOURCE**' button and select another input source to exit Media OSD

CONTROL AND FUNCTION

Media Card Interface

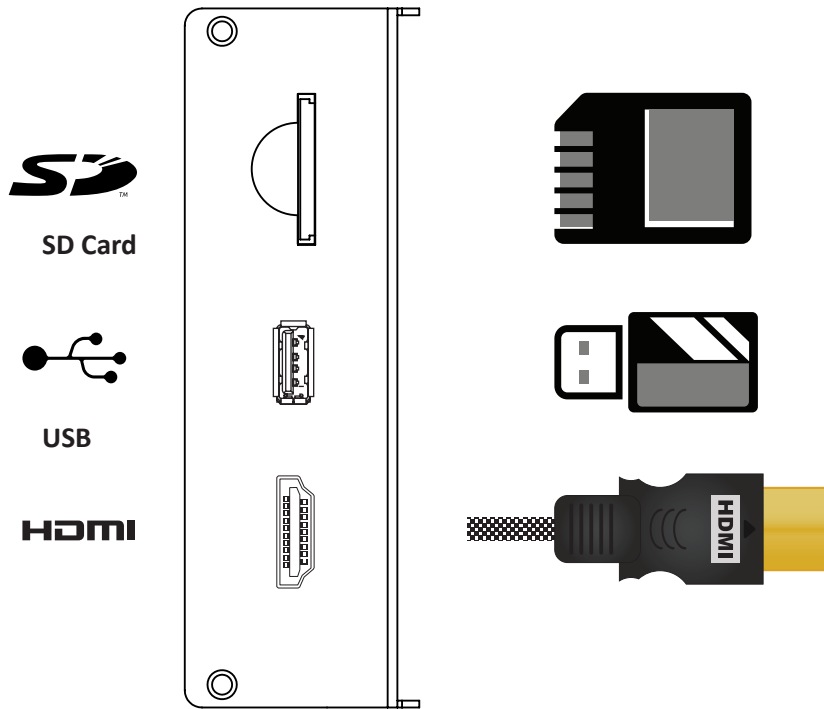

- **Connect USB or SD card**
 1. Connect USB or SD card devices to USB or SD Card slot located at the back of the PVM
- **Remove USB or SD card**
 1. Return to the main menu and press exit
 2. Remove the USB & SD card from the slot

Media Player OSD

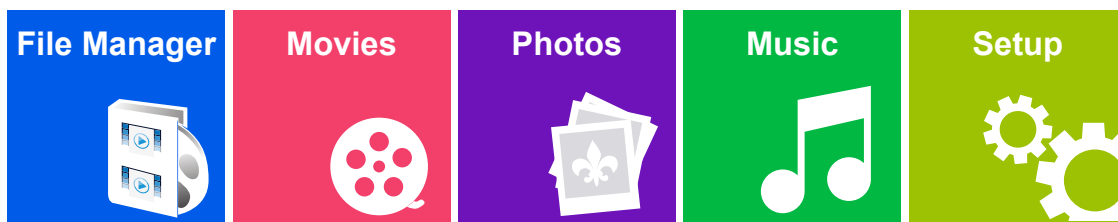

FUNCTION	
File Manager	Displays all available video, photo and music files
Movies	Plays video files from the SD Card or USB
Photos	Displays image files from the SD Card or USB
Music	Plays music files from the SD Card or USB
Setup	Adjusts Audio, Video and System Effect

CONTROL AND FUNCTION

File Manager

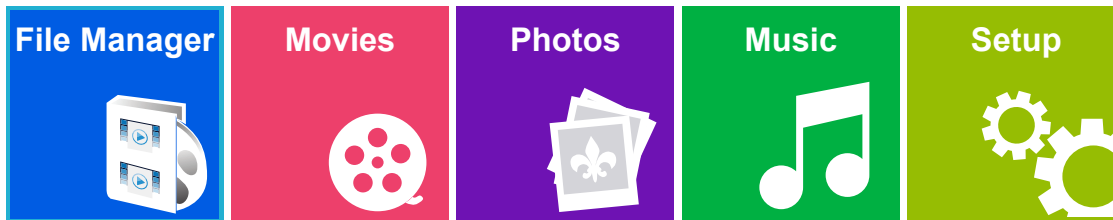

When you select **File Manger** on the entry menu of Media play:

1. Press the **ENTER** button and then press ◀ / ▶ / ▲ / ▼ buttons to select a file to play or display.
2. Press the **ENTER** button again to play the video file or display the image / slide-show.
3. Press ■ button to stop playing the video file or displaying the image file / slide-show.
4. Press ▶ || button to play or pause the video file.
5. Press the **EXIT** button to return to the **Media OSD MENU**

Movies

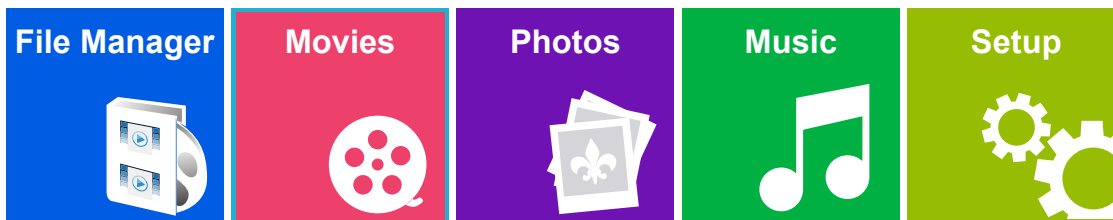

When you select **Moives** on the entry menu of Media play:

1. Press the **ENTER** button and then press ◀ / ▶ / ▲ / ▼ buttons to select a video file to play.
2. Press the **ENTER** button again to play the video file.
3. Press ■ button to stop the video file.
4. Press ▶ || button to pause the video file.
5. Press the **EXIT** button to return to the **Media OSD MENU**

CONTROL AND FUNCTION

Photos



When you select **Photos** on the entry menu of Media play:

1. Press the **ENTER** button and then press ◀ / ▶ / ▲ / ▼ buttons to select a image file to display.
2. Press the **ENTER** button again to display the image or slide-show.
**Note: If you have more than one image file, the "slide-show" mode will activate automatically*
3. Press ■ button to stop displaying.
4. Press ▶ || button to pause the slide-show and show only one image file in a non "slide-show" mode.
5. Press the **EXIT** button to return to the **Media OSD MENU**

Music

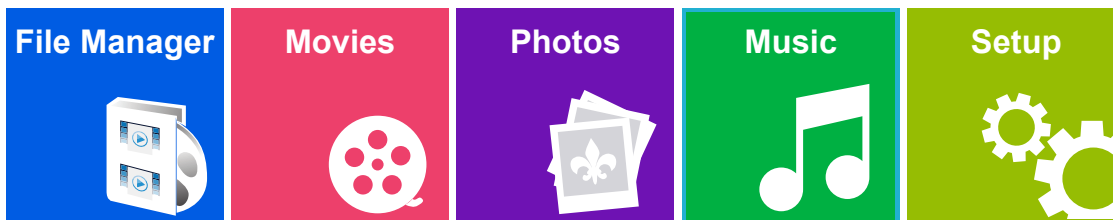

When you select **Music** on the entry menu of Media play:

1. Press the **ENTER** button and then press ◀ / ▶ / ▲ / ▼ buttons to select a file to play.
2. Press the **ENTER** button again to play the music file.
3. Press ■ button to stop playing.
4. Press ▶ || button to pause.
5. Press the **EXIT** button to return to the **Media OSD MENU**

CONTROL AND FUNCTION

Setup

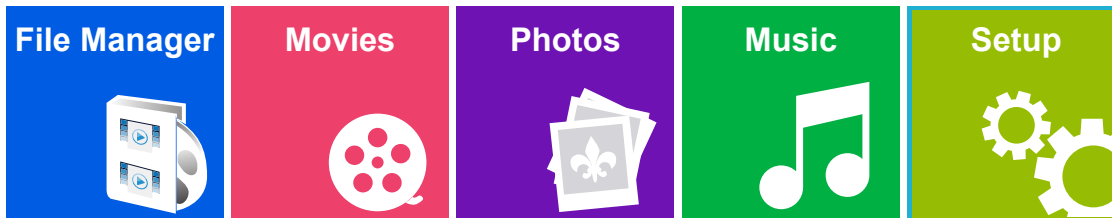

When you select **Setup** on the entry menu of Media play:

1. Press the **ENTER** button and then press ◀ / ▶ buttons to select between Video / Audio / System setup.
2. Select **Video** and then press ▲ / ▼ button to select the parameters which you want to adjust.
3. Press the **ENTER** button again to select and adjust the details.
4. Press the **EXIT** button to return to the **Media OSD MENU**

Setup - Video

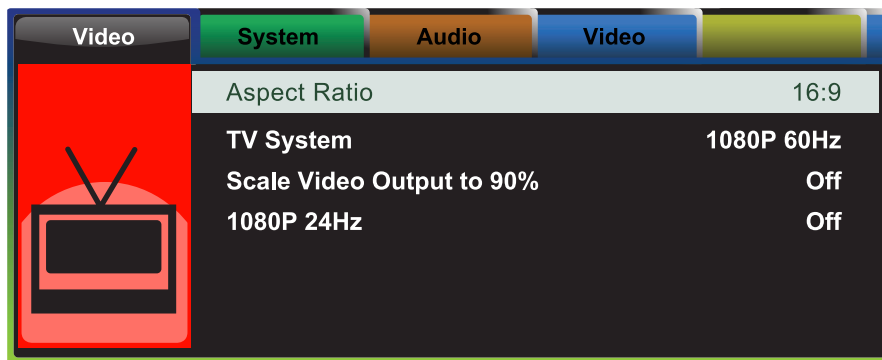

◀ ▶ Change category
● Video

FUNCTION		VALUE
Aspect Ratio	Adjusts the video format of the images	Pan Scan 4:3 / Letter Box 4:3 / 16:9 / 16:10
TV System	Selects the video format	720p 50&60Hz / 1080i 50&60Hz 1080P 50&60Hz / NTSC / PAL / 480P / 576P
Scale Video Output to 90%	Sets up the scale of the video	Off / On
1080P 24Hz	Selects the low frequency video	Off / On

CONTROL AND FUNCTION

Setup - Audio

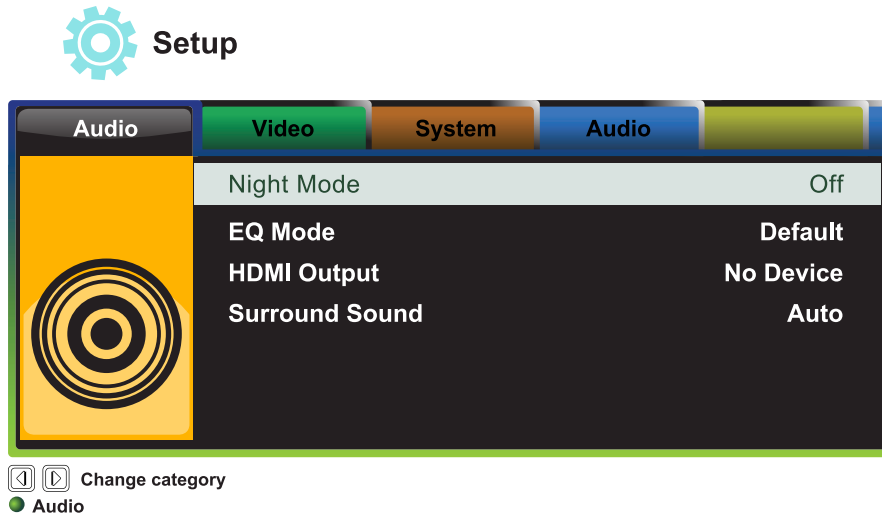

When you select **Setup** on the entry menu of Media play:

1. Press the **ENTER** button and then press ◀ / ▶ buttons to select between Video / Audio / System setup.
2. Select **Audio** and then press ▲ / ▼ buttons to select the parameters to adjust.
3. Press the **ENTER** button again to select and adjust the details.
4. Press the **EXIT** button to return to the **Media OSD MENU**

FUNCTION		VALUE
Night Mode	Plays music at a lower volume	Off / On / Comfort
EQ Mode	Selects different EQ settings	Default / Pop / Live / Club / Rock / Bass / Treble Vocal / Powerful / Dance / Soft / Party / Classical
HDMI Output	Selects the output format of HDMI	HDMI LPCM, HDMI RAW, HDMI Auto
Surround Sound	Selects the surround mode	Auto / 5.1 CH / HD Audio

CONTROL AND FUNCTION

Setup - System

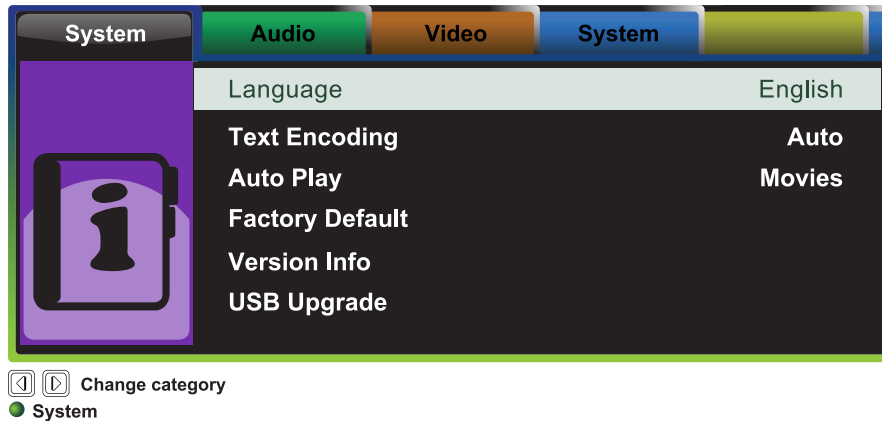

When you select **Setup** on the entry menu of Media play:

1. Press the **ENTER** button and then press ◀ / ▶ buttons to select the Video / Audio / System setup.
2. Select **System** and then press ▲ / ▼ button to select the parameters to adjust.
3. Press the **ENTER** button again to select and adjust the details.
4. Press the **EXIT** button to return to the **Media OSD MENU**

FUNCTION		VALUE
Language	Selects the language of the OSD menu	English / Chinese / Japanese / Espanol French / Deutsch / Italian / Korean Greek / Portuguese
Text Encoding	Selects the language of encoding the text	Unicode(UTF8) / Western / Central European Greek / Cyrillic / Turkish / SE European Japanese (S-JIS) / Korean (EUC-KR) / Chinese
Auto Play	Selects an auto play file-type	Off / Movies / Photos / Music
Factory Default	Returns all settings back to factory default	Yes / No
Version Info	Shows the current media card version info	VER: Media Box 3.60.000091U
USB Upgrade	Selects USB to upgrade the firmware	Yes / No