

# Extension Column Connector

ISSUED: MAR. 2013

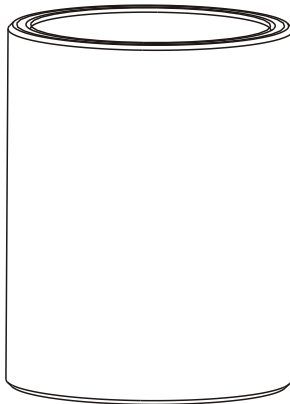

**NOTE:** Read the entire instruction manual before you start installation and assembly.

## **WARNING**

- Do not begin the installation until you have read and understood all the instructions and warnings contained in this installation sheet. If you have any questions regarding any of the instructions or warnings, please contact your local distributor.
- Improper installation of this product may cause damage or serious injury.
- Tighten screws firmly, but do not over tighten. Over tightening can cause damage to the items, This greatly reduces their holding power.

## Component Checklist

**IMPORTANT:** Ensure that you have received all parts according to the component checklist prior to installation. If any parts are missing or faulty, telephone your local distributor for a replacement.



extension column connector (x1)  
A

### Package M



set screw(x2)  
M-A



Allen key (x1)  
M-B

## Attaching the extension column connector to the extension columns

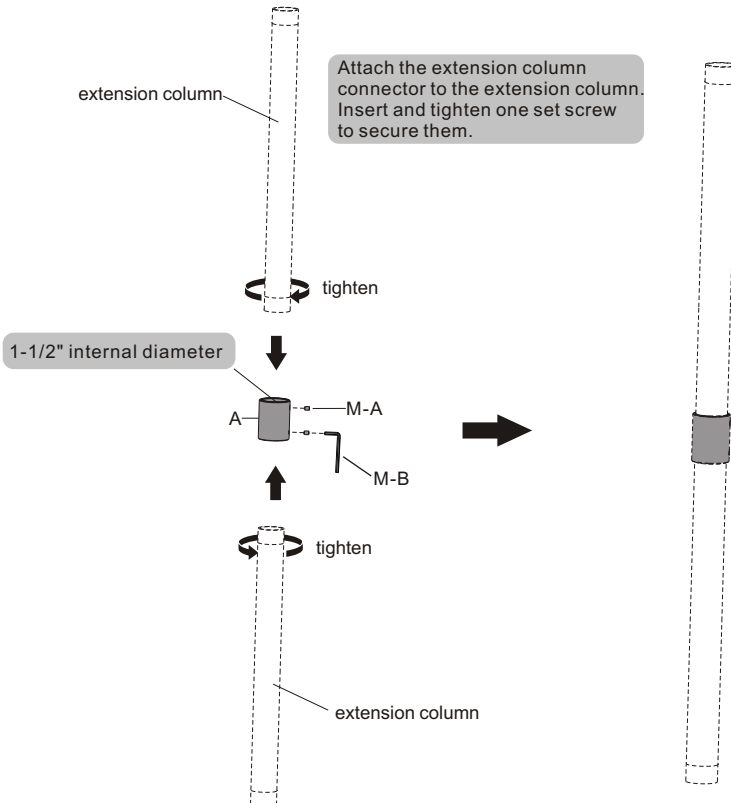

Repeat the previous step for second extension column.