

VZ-1TRX

HDMI CAT 5/5e/6 Extender with IR

EXTENDER USER MANUAL



ViewZ®
www.viewzusa.com

Please read this manual thoroughly before use, and keep it handy for future reference.

SAFETY INSTRUCTION

Important Safety Instruction

Mark Indication and Substance



CAUTION : TO REDUCE THE RISK OF ELECTRICAL SHOCK,
DO NOT REMOVE COVER (OR BACK). NO USER
SERVICEABLE PARTS INSIDE. REFER SERVICING TO
QUALIFIED SERVICE PERSONNEL



This symbol is intended to alert the user to the presence of uninsulated & dangerous voltage within the monitor's enclosure that may be of sufficient magnitude to constitute a risk of electric shock to persons.



This symbol is intended to alert the user to the presence of important operating and maintenance (servicing) instructions in the literature accompanying the monitor.

Warning

1. Read all warnings.
2. Do not expose this unit to rain, heavy moisture, or liquid
3. Do not repair the device or open the enclosure without professional guidance to avoid electric shocks. Doing so may void your warranty
4. Keep the product in a well-ventilated location to avoid damage from overheating
5. Turn off the power and make sure the environment is safe before installation
6. Do not plug the HDMI cables and IR cables in/out when the device is in use to avoid cable damage. Make sure they are plugged into the correct ports
7. Use the included DC5V power adapters only. Make sure the specification matches if using 3rd-party DC power adapters

The HDMI CAT 6 Extender with IR - 394 ft extends high definition 1080p HDMI signals from a source device to a display device up to 394 ft (120 meters) using an economical CAT 5/5e/6 cable.

Nominal Operating Temperature & Humidity

- Operating Temperature : 32°F ~ 104°F / 0°C ~ 40°C
- Operating Humidity : 20 ~ 90% RH

INSTALLATION

Installation Tools

The following tools may be required depending on your installation.

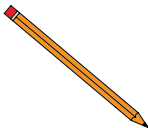
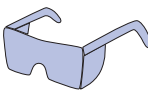
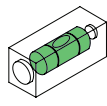
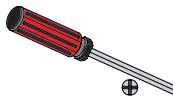
				
Electronic Stud Finder	Pencil	Protective Eye-wear	Level	Phillips Screwdriver

Assembly Components - provided

Your ViewZ monitor is shipped with all proper installation hardware and components. If there are parts missing and/or damaged, please stop the installation and contact ViewZ USA at (888)-998-4399.

			
Transmitter TX (Qty 1), Receiver RX (Qty 1)	Power Supply (Qty 2)	IR Receiver Cable (Qty 1), IR Blaster Cable (Qty 1)	User Manual (Qty 1)

CONNECT EXTERNAL EQUIPMENTS

Interface Input Ports

The following image is the description of interface input & output ports of 1TRX extender.

Receiver (RX)

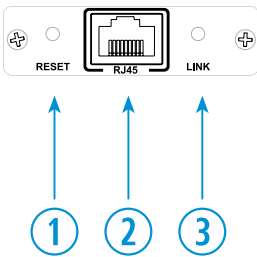

Transmitter (TX)

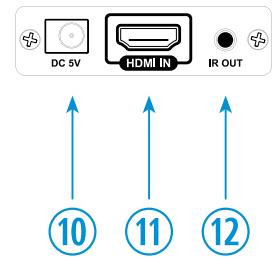
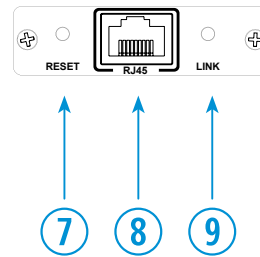
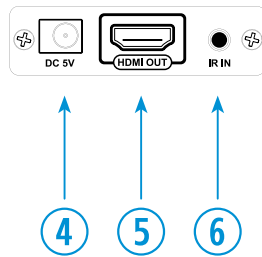

1. RESET - Reset the receiver(RX)
2. RJ45 In -Connect to the transmitter(TX)'s RJ45 output port by using a CAT 5/5e/6 cable
3. LINK LED - Light up when RJ45 connected from TX. If flashing, RJ45 is not connected from TX
4. DC5V - Connect to the provided power supply
5. HDMI Out - Connect to the monitor
6. IR In - Connect to the IR receiver (which provided)
7. RESET - Reset the transmitter(TX)
8. RJ45 Out -Connect to the receiver(TX)'s RJ45 input port by using a CAT 5/5e/6 cable
9. LINK LED - Light up when HDMI input source is detected. If flas, no HDMI input source is detected
10. DC5V - Connect to the provided power supply
11. HDMI In - Connect to the HDMI source device
12. IR Out - Connect to the IR blaster (which provided)

Installation Process

1. Turn off all devices including your HDMI source and HDMI display.
2. Connect your HDMI source to the **Transmitter's** HDMI Input port with a HDMI cable (HDMI cable not included).
Optional: Connect the **IR Blaster Extension Cable** to the **Transmitter's** IR output port. Face the (IR Blaster) eye towards your HDMI source's IR window. This connection is needed if you want to control your HDMI source from the remote location.
3. Plug your CAT5e/6/7 cable between the **Transmitter's** RJ45 Output and **Receiver's** RJ45 Input.
4. Connect your monitor to the **Receiver's** HDMI output port with a HDMI cable (HDMI cable not included).
Optional: Connect the **IR Receiver Extension Cable** to the **Receiver's** IR input port. This connection is needed if you want to control your HDMI source from the remote location.
5. Plug the provided power adapters into the **Transmitter's** and **Receiver's** power jacks (DC 5V), then plug both power adapters into a reliable power source.
6. Turn on all connected devices.
7. The HDMI extender is ready for use.

SPECIFICATION

Model No.	VZ-1TRX
Resolution	720x576 @50Hz, 640x480 @60Hz, 800x600 @60Hz, 1024x768 @60Hz, 1280x720 (720p) @60Hz, 1280x800 @60Hz, 1280x1024 @60Hz, 1440x900 @60Hz, 1680x1050 @60Hz, 1920x1080 (1080p) @60Hz
Video Bandwidth	225MHz (10.2Gbps), HDMI 1.3 Compliance, HDCP 1.4 Compliance
Data Transmission	< 200ms
Network Cable	UTP & STP over Cat 5 / Cat 5e / Cat 6
Transmission Distance	CAT 6 - 394 ft (120m) / CAT 5e - 328ft (100m) / CAT 5 - 262ft (80m)
Audio Support	PCM 2ch
IR Signal	20 ~ 60 kHz
Net Weight	TX - 0.15 lbs (70 g) / RX - 0.15 lbs (70 g)
Gross Weight	0.95 lbs (430 g)
Operating Temperature	32 - 104°F / 0 - 40°C
Operating Humidity	20 ~ 90% RH
Electrical Ratings	5V DC, 1A
Power Consumption	TX : 2 W / RX: 2 W
Safety & EMC Certification	CE / FCC / ROHS / IEEE T568B
INTERFACE	Transmitter TX - Power Input (DC 5V) x1, RJ45 Out x1, HDMI In x1, IR In x1, Reset x1 Receiver RX - Power Input (DC 5V) x1, RJ45 In x1, HDMI Out x1, IR Out x1, Reset x1
Accessories	Power Adapter x2, Transmitter TX x1, Receiver RX x1, User's Manual x1, IR Blaster Extension Cable x1, IR Receiver Extension Cable x1

TROUBLESHOOTING GUIDE

- Check the following before calling for service.
- If the same problems continue after checking, contact the reseller you purchased the monitor from.

At start	We recommend that you test with different input sources when you have trouble with the current input source. If symptom persists, follow the instructions below. After following the instructions below, please contact us at 1-888-99-VIEWZ.
No image or Noise on the screen	<ul style="list-style-type: none"> - Make sure the cable is correctly plugged into the outlet - Make sure the power cable is correctly plugged into the transmitter & receiver - Make sure the cable is correctly connected between monitor & receiver (RX) - Check brightness and see if brightness is set to '0' - Check video source - Press the Receiver's reset button to reset the unit. - Use the shorter network cable.
Receiver's Link LED is flashing	<ol style="list-style-type: none"> 1) Make sure the network cable follows the IEEE-568B wiring standard. 2) Check the Transmitter (TX) correctly connected HDMI input. 3) Reset both TX & RX and reconnect.
The extender is not working properly	<ol style="list-style-type: none"> 1) Please check the cable lengths: HDMI cables: Up to 5m, Network cables (CAT5e/6): Up to 130m 2) Press the reset button on the TX/RX and reconnect.
RX Link LED is on but there is no image	<ol style="list-style-type: none"> 1) Press RX reset button to reset the unit. 2) Make sure the HDMI cable is firmly connected to the monitor. 3) Make sure your HDMI monitor is set to the correct HDMI input. 4) Use the high quality network cable.

Disclaimer

ViewZ USA intends to make this manual accurate and complete. However, ViewZ USA makes no claim that the information contained herein covers all details, conditions or variations, nor does it provide for every possible contingency in connection with the installation or use of this monitor. The information contained in this document is subject to change without notice or obligation of any kind. ViewZ USA makes no representation of warranty, expressed or implied, regarding the information contained herein. ViewZ USA assumes no responsibility for accuracy, completeness or sufficiency of the information contained in this document.

Contact Us

NORTH AMERICA

177 W. Orangethorpe Ave.
 Placentia, CA 92870
 USA and Canada
 Phone: 1-888-998-4399
 Fax: 1-714-996-1138
 Other Locations
 Phone: (001) 888-998-4399
 Fax: (001) 714-996-1138

NOTE

This image shows a full page of blank, lined paper. It features approximately 20 evenly spaced horizontal grey lines across its entire width, typical of notebook or legal stationery. The paper is otherwise completely empty, with no margins, text, or other markings.



THANK YOU FOR CHOOSING VIEWZ

VIEWZUSA.COM
