

VZ-CM-P15 ADVANTAGES

- 1 - 1/2" NPT Standard Pipe Thread
- Powder-Coated Surface
- Fast and Easy installation
- Adjustable length Min. 8.7" ~ Max. 14.55" (220mm ~ 370mm)
- 2-3 units of VZ-CM-P15 poles can be connected by using VZ-CM-C Pole connector.

Connecting more than 3 poles is not recommended.

Designed specifically for

- VZ-CM-V1** 23"-42" VESA Mounting Head
- VZ-CM-V3** 37"-70" Universal Mounting Head
- VZ-CM-C** Extension Column Connector
- VZ-CM-T** Tilt Ceiling Plate

FEATURES

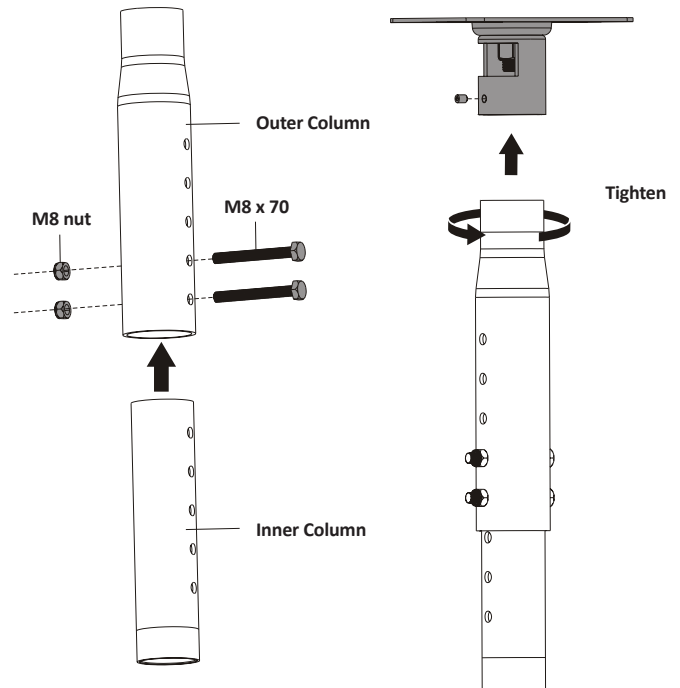

| MODEL # | | VZ-CM-P15 |
|-------------------|---|-----------|
| FEATURES | | |
| Net Weight | 2.11 lbs / 0.96 kg | |
| Weight Capacity | 110 lbs / 50 kg | |
| Pole (R x Length) | Ø 59 x 280-370 mm / Ø 2.32 x 8.7 - 14.55" | |
| Thread | Ø 38.1 mm / 1-1/2" | |

Contact ViewZ

- Address : 177 W. Orangethorpe Ave., Placentia, CA 92870
- Phone : (714) 996-1177, Fax : (714) 996-1138
- Sales : sales@viewzusa.com
- Specification subject to change without notice.

DIMENSIONS

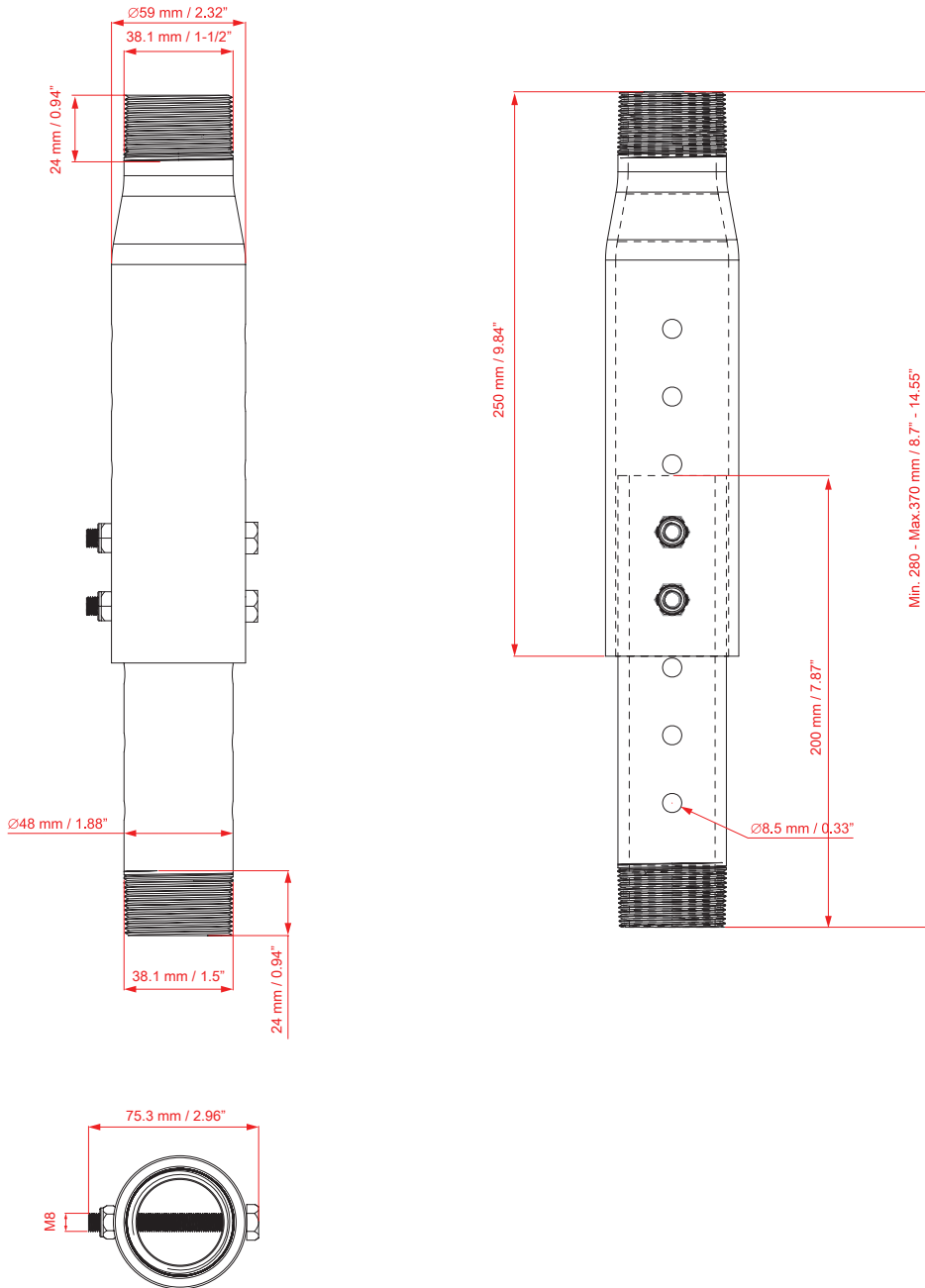

Contact ViewZ

- Address : 177 W. Orangethorpe Ave., Placentia, CA 92870
- Phone : (714) 996-1177, Fax : (714) 996-1138
- Sales : sales@viewzusa.com
- Specification subject to change without notice.