

# VZ-49UHD

## 4K UHD QUAD VIEW SECURITY & VIDEO WALL MONITOR



### ADVANTAGES

- 49" 4K UHD LED Panel
- Narrow **9.1 mm** Bezel
- Supports **Quad** View Mode
- Supports **Landscape & Portrait** Mode
- Supports 4K (3840X2160) Resolution
- Supported HDMI (2.0 & 1.4) In x2, DP(1.2) In x2
- USB, SD Card - Media Player
- OPS Slot - Optional Windows OPS available
- Wide Viewing Angle (IPS Panel)
- Auto Source Detection / Auto Power Recovery
- Built-to Run 24/7/365



| MODEL #                 |                                 | VZ-49UHD                                                                                                                                     |
|-------------------------|---------------------------------|----------------------------------------------------------------------------------------------------------------------------------------------|
| <b>FEATURES</b>         |                                 |                                                                                                                                              |
| Screen Size             | 49"                             |                                                                                                                                              |
| Max. Resolution         | 3840 x 2160 @60Hz               |                                                                                                                                              |
| Pixel Pitch             | 0.27963 mm x 0.27963 mm         |                                                                                                                                              |
| Brightness              | 350cd/m <sup>2</sup> (Typical)  |                                                                                                                                              |
| Contrast Ratio          | 1200:1                          |                                                                                                                                              |
| Aspect Ratio            | 16 : 9 (1.78 : 1)               |                                                                                                                                              |
| Viewing Angle (H/V)     | 178° / 178°                     |                                                                                                                                              |
| Display Color           | 1.07G                           |                                                                                                                                              |
| Response Time           | < 9 ms                          |                                                                                                                                              |
| <b>INTERFACE</b>        |                                 |                                                                                                                                              |
| HDMI (1.4) In           | 1                               |                                                                                                                                              |
| HDMI (2.0) In           | 1                               |                                                                                                                                              |
| DP In / Out             | 2 / 1                           |                                                                                                                                              |
| RS-232 (RJ-45) In / Out | 1 / 1                           |                                                                                                                                              |
| Audio Out               | 1                               |                                                                                                                                              |
| USB In                  | 1 (Media Player) / 1 (OPS Only) |                                                                                                                                              |
| SD Card In              | 1 (Media Player)                |                                                                                                                                              |
| OPS (Option)            | USB Type C                      | 1                                                                                                                                            |
|                         | USB 2.0 Type A                  | 2                                                                                                                                            |
|                         | USB 3.0 Type A                  | 2                                                                                                                                            |
|                         | Ethernet (RJ-45) In             | 1                                                                                                                                            |
|                         | HDMI Out                        | 1                                                                                                                                            |
|                         | Mic. In / Audio Out             | 1 / 1                                                                                                                                        |
| <b>SPECIAL FEATURES</b> |                                 |                                                                                                                                              |
| Bezel Width             | Top & Left Side                 | 0.37" / 9.5 mm                                                                                                                               |
|                         | Bottom & Right Side             | 0.35" / 9.1 mm                                                                                                                               |
|                         | Active to Active Area           | 0.72" / 18.6 mm                                                                                                                              |
| Landscape & Portrait    | Support                         |                                                                                                                                              |
| Quad View               | Support                         |                                                                                                                                              |
| Media Player            | Video Codec                     | WMA/WMV, AAC, AC3, DIVX, MPEG, H264, VC1, AVS, FLV, RM/RMVB                                                                                  |
|                         | Video Format                    | AVI, MXF, MP4, FLV, MKV, ASF, DAT, RM, RMVB, AMV, F4V, M4V, H.265, VOB, ISO, M2TS, 3GP, 3G2, M2V, MOV, MPG, WMV, MTV, OGV, TS, WEBM, DV, SWF |
|                         | Music Format                    | MP3, FLAC, APE, WAV, WMA, DTS, AAC, M4R, MKA, MP2, AMR, WV, M4A, AC3, AU, AIFF, M4B                                                          |
|                         | Image Format                    | JPEG, JPG, BMP, GIF                                                                                                                          |
|                         | Text Format                     | TXT (raw text file only)                                                                                                                     |
|                         | Capacity                        | Max 16GB                                                                                                                                     |
|                         |                                 |                                                                                                                                              |

|                                 |                                                                     |                                                   |
|---------------------------------|---------------------------------------------------------------------|---------------------------------------------------|
| <b>AUDIO</b>                    |                                                                     |                                                   |
| Built in speaker                | 5W x 2                                                              |                                                   |
| <b>REFRESH RATE</b>             |                                                                     |                                                   |
| HDMI (2.0) In                   | 3840 x 2160 @ 60Hz                                                  |                                                   |
| HDMI (1.4) In                   | 3840 x 2160 @ 30Hz                                                  |                                                   |
| DP (1.2) In                     | 3840 x 2160 @ 60Hz                                                  |                                                   |
| <b>DIMENSIONS &amp; WEIGHT</b>  |                                                                     |                                                   |
| Outline Dimension (W x H x D)   | Without Stand                                                       | 43.07 x 24.62 x 2.03" / 1094.2 x 625.4 x 51.7 mm  |
|                                 | With Stand                                                          | 43.07 x 26.25 x 7.08" / 1094.2 x 666.8 x 180.0 mm |
| Net Weight                      | 36.15 lb / 16.4 kg                                                  |                                                   |
| Gross Weight                    | 52.91 lb / 24 kg                                                    |                                                   |
| <b>MOUNT</b>                    |                                                                     |                                                   |
| VESA                            | 400 x 400 mm (M6 x 4)                                               |                                                   |
| <b>GENERAL</b>                  |                                                                     |                                                   |
| Transmitter - IR Remote Control | YES                                                                 |                                                   |
| Power                           | Electrical Ratings                                                  | AC100 ~ 240V (50/60Hz)                            |
|                                 | Consumption                                                         | ≤ 160 W / ≤ 180 W (with OPS)                      |
| Operating Temperature           | 32 ~ 104°F / 0°C ~ 40°C                                             |                                                   |
| Operating Humidity              | 20 ~ 85% RH                                                         |                                                   |
| Storage Temperature             | 50 ~ 140°F / 10°C ~ 60°C                                            |                                                   |
| Storage Humidity                | 10 ~ 90% RH                                                         |                                                   |
| Language (OSD)                  | English, Spanish, French, Portuguese, Japanese                      |                                                   |
| Compatible Mounts               | Wall                                                                | VZ-AM03, VZ-WM71, VZ-XMS                          |
|                                 | Ceiling                                                             | VZ-CMKIT-04                                       |
| Accessories                     | Stand (1set), Manual (1pc), Power Cable (1pc), Remote Control (1pc) |                                                   |

### Contact ViewZ

- Address : 177 W. Orangethorpe Ave., Placentia, CA 92870
- Phone : (714) 996-1177, Fax : (714) 996-1138
- Sales : sales@viewzusa.com

# VZ-49UHD

**ViewZ**<sup>®</sup>  
DRIVING VISUAL INNOVATION

**4K UHD QUAD VIEW SECURITY & VIDEO WALL MONITOR**

## DIMENSION

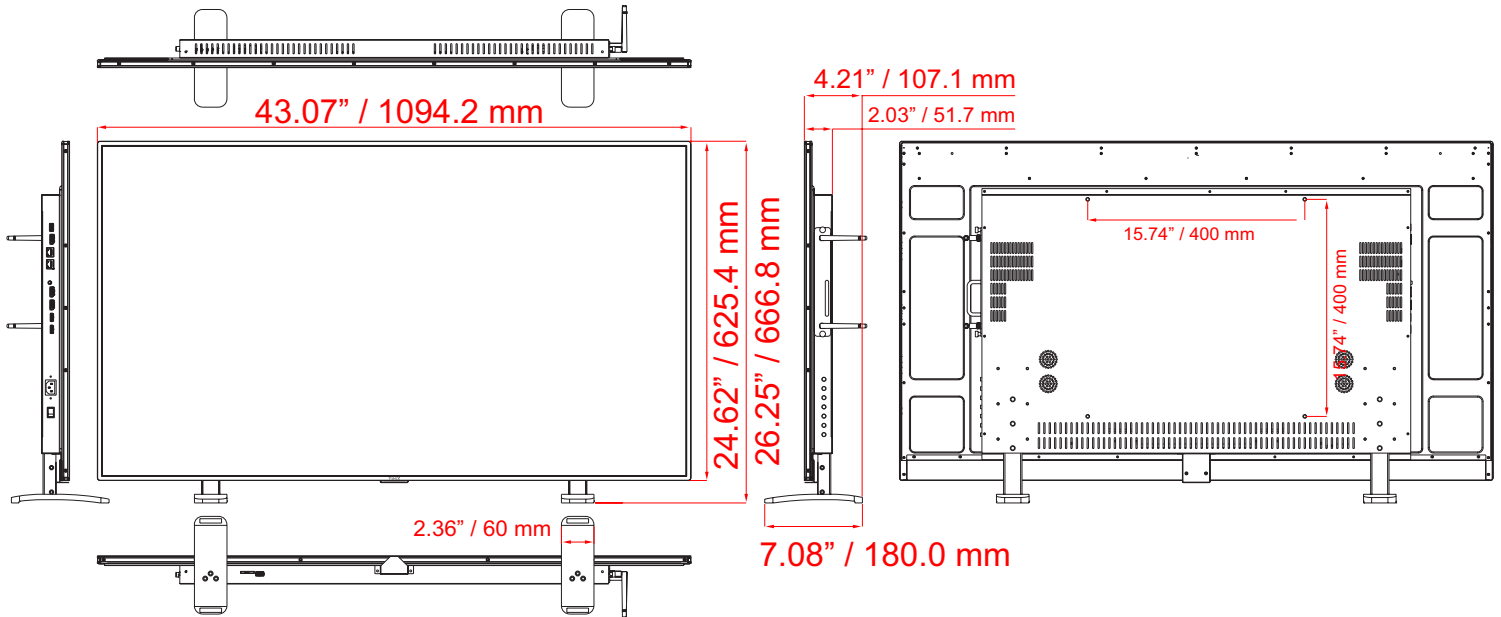

## INTERFACE

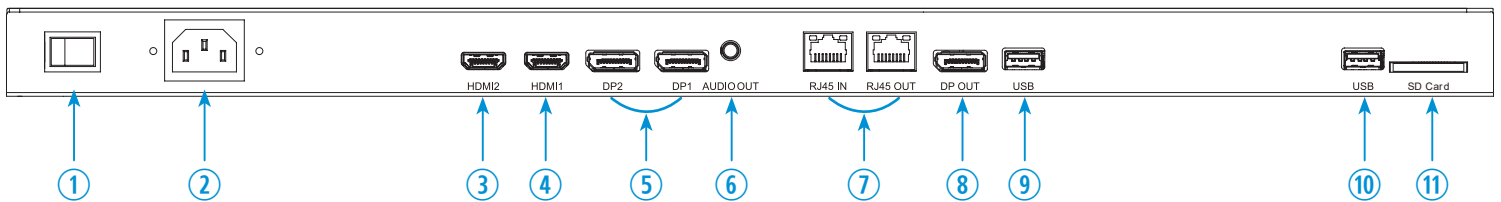

1. Power On/Off
2. AC 100 ~ 240 V
3. HDMI IN (Ver 1.4) x1
4. HDMI IN (Ver 2.0) x1
5. DP IN x2
6. AUDIO OUT x1
7. RJ45 (RS-232) IN / OUT x1/1
8. DP OUT x1
9. USB (OPS Only) IN x1
10. Media Player USB IN
11. Media Player SD Card IN

## Contact ViewZ

- Address : 177 W. Orangethorpe Ave., Placentia, CA 92870
- Phone : (714) 996-1177, Fax : (714) 996-1138
- Sales : sales@viewzusa.com